

PRELIMINARY ISSUE
THIS PLAN ISSUED FOR
ADVANCE INFORMATION ONLY

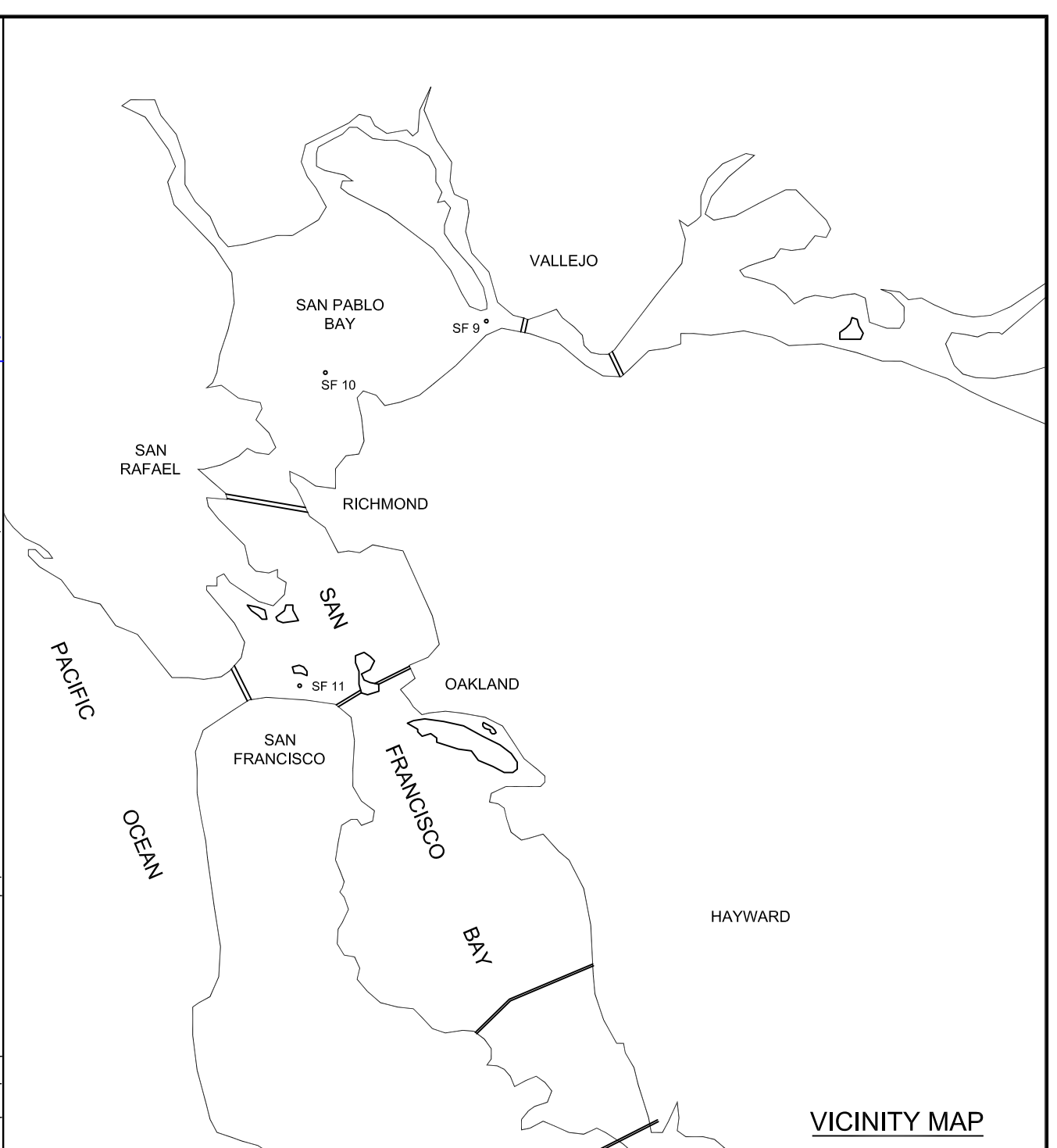
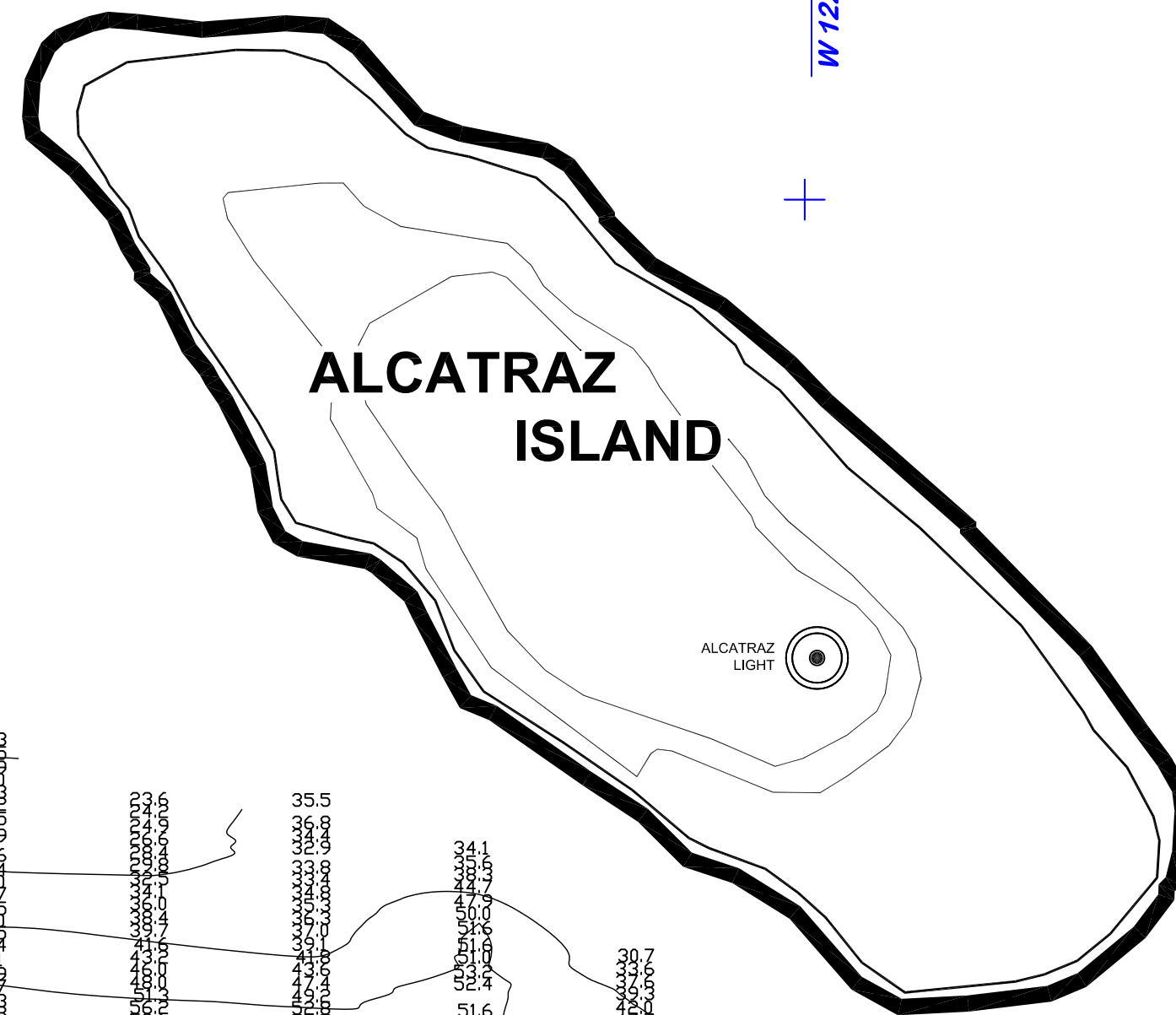

LAMBERT COORDINATES			
POINT	X	Y	
U.S.G.S. MON. 57	ELEV. - 14.00	6,005,367	2,123,290
TRANSAMERICA BUILDING		6,011,912	2,117,586
ALCATRAZ DISPOSAL SITE - (SF-11)			
1,000 FT. RADIUS		6,005,935	2,127,235
ALCATRAZ LIGHT		6,006,552	2,129,010
ALCATRAZ BUOY		6,006,367	2,127,186

NOTES:
DRAWING NOT TO BE USED AS NAVIGATION.
ONLY CHANNEL CONDITION AT DATE OF SURVEY.
THE LOCATION OF ALL NAVIGATION AIDS ARE BASED ON INFORMATION PROVIDED BY THE U.S. COAST GUARD.
BUOY LOCATIONS REPRESENT THE POSITION OF THE SINKER ONLY.
INFORMATION DEPICTED ON THIS MAP REPRESENTS THE RESULTS OF SURVEYS MADE ON THE DATES INDICATED AND CAN ONLY BE CONSIDERED AS INDICATING THE GENERAL CONDITIONS EXISTING AT THAT TIME.
SURVEYED BY THE CORPS OF ENGINEERS.
SOUNDINGS ARE TAKEN BY FATHOMETER AND ARE SHOWN TO THE NEAREST FOOT AND TENTHS OF A FOOT.
SOUNDINGS ARE BASED ON THE DATUM OF MEAN LOWER LOW WATER AT THE LOCALITY.
PLANE GRID, BEARING AND COORDINATES ARE BASED ON THE STATE OF CALIFORNIA, COORDINATE SYSTEM, LAMBERT CONFORMAL PROJECTION, ZONE III NAD 83, CALIFORNIA, AS DESCRIBED IN SPECIAL PUBLICATION NO. 253, PUBLISHED BY NATIONAL OCEAN SURVEY.
THE PROJECT DEPTH IS 40 FEET AT M.L.L.W.
SOUNDINGS ARE BASED ON THE TIDE GAUGE LOCATED AT THE HYDE STREET PIER, SAN FRANCISCO, CALIFORNIA.
VERTICAL CONTROL
BENCHMARK "56" ELEV. 12.71 FT MLLW
HORIZONTAL CONTROL
COAST GUARD D-BEACON

SYMBOL	DESCRIPTION	DATE	APPROVAL
REVISIONS			
DRAWN BY: PDT		SAN FRANCISCO CO. CALIFORNIA	
CHECKED BY: PDT		ALCATRAZ DISPOSAL SITE - SF11 CONDITION SURVEY 8 JANUARY 2014	
DESIGNED BY: PDT			
SUBMITTED: PDT		APPROVED: _____ DATE: _____	
HYDRO SURVEY TEAM LEADER:		CHIEF, CONSTRUCTION BRANCH	
APPROVAL RECOMMENDED:		CHIEF, CONSTRUCTION BRANCH	
PREPARED UNDER THE DIRECTION OF JOHN K. BAKER LT. COLONEL, C.E., DISTRICT ENGINEER			
SCALE: 1"=200'		JOB NO.: _____	
DRAWING NUMBER		SHEET: 1 OF 1 1 2 XXX	

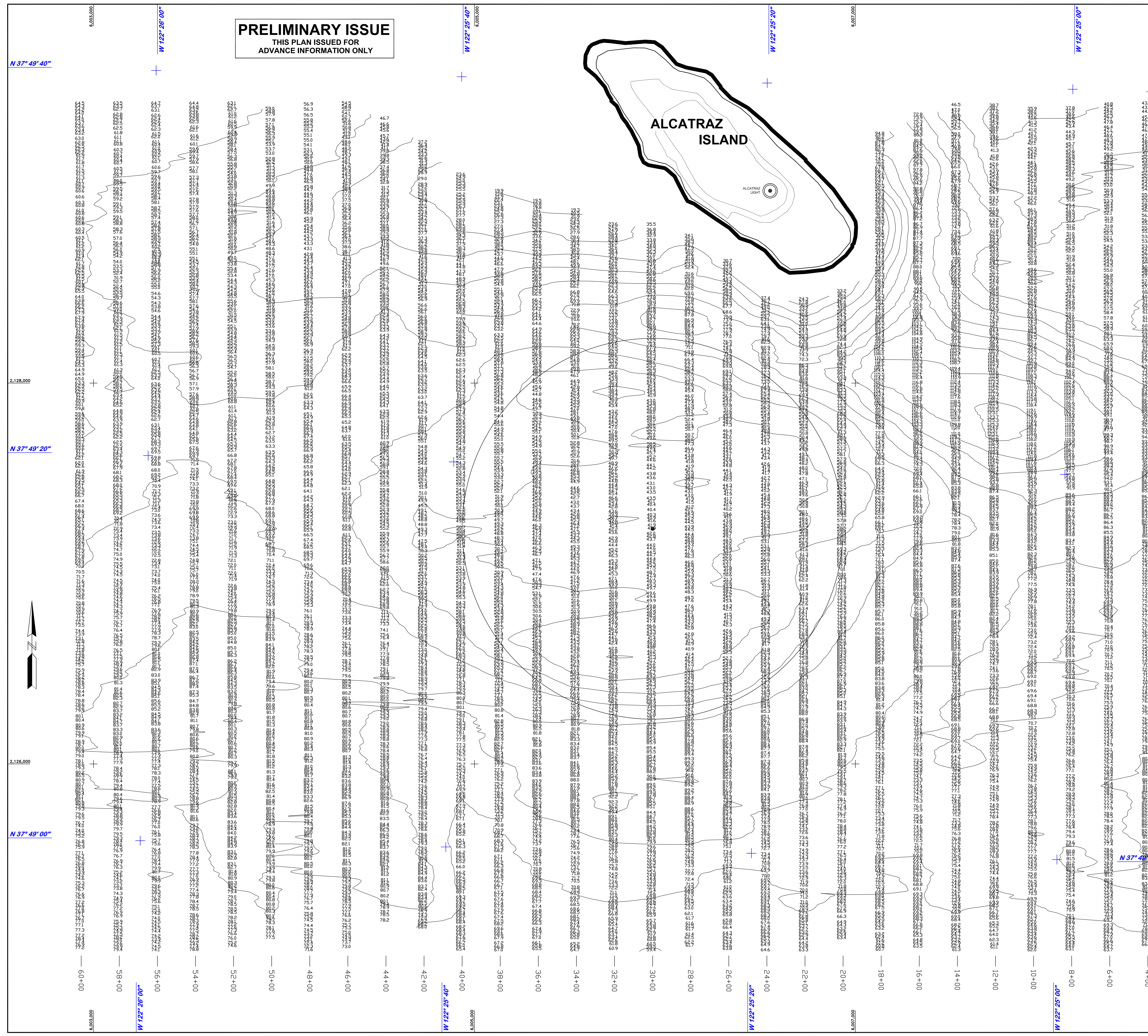

N 37° 49' 40"

W 122° 26' 00"

W 122° 26' 00"

W 122° 26' 20"

W 122° 26' 00"

2,128,000

N 37° 49' 20"

2,128,000

N 37° 49' 00"

W 122° 24' 40"

W 122° 24' 40"

W 122° 24' 40"

W 122° 24' 40"

N 37° 49' 00"

63+00
59+00
54+00
52+00
50+00
48+00
46+00
44+00
42+00
40+00
38+00
36+00
34+00
32+00
30+00
28+00
26+00
24+00
22+00
20+00
18+00
16+00
14+00
12+00
10+00
8+00
6+00

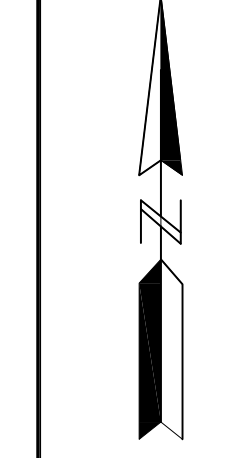

6069999

2,128,000

2,128,000

6069999