

PURPOSE: BERTH DREDGING

DATUM: MLLW

CORPS FILE NUMBER: 2012-00356S

PROJECT LOCATION MAP

BERTH DREDGING

USCG BASE ALAMEDA
 COAST GUARD ISLAND
 ALAMEDA, CALIFORNIA

BERTH DREDGING

IN: ALAMEDA

AT: USCG BASE ALAMEDA

COUNTY OF: ALAMEDA **STATE:** CA

APPLICATION BY: USCG

SHEET: 1 OF 4 **DATE:** 13 FEB 2015



PURPOSE: BERTH DREDGING

DATUM: MLLW

CORPS FILE NUMBER: 2012-00356S

PROJECT AREA MAP

BERTH DREDGING

USCG BASE ALAMEDA
COAST GUARD ISLAND
ALAMEDA, CALIFORNIA

BERTH DREDGING

IN: ALAMEDA

AT: USCG BASE ALAMEDA

COUNTY OF: ALAMEDA **STATE:** CA

APPLICATION BY: USCG

SHEET: 2 OF 4 **DATE:** 13 FEB 2015

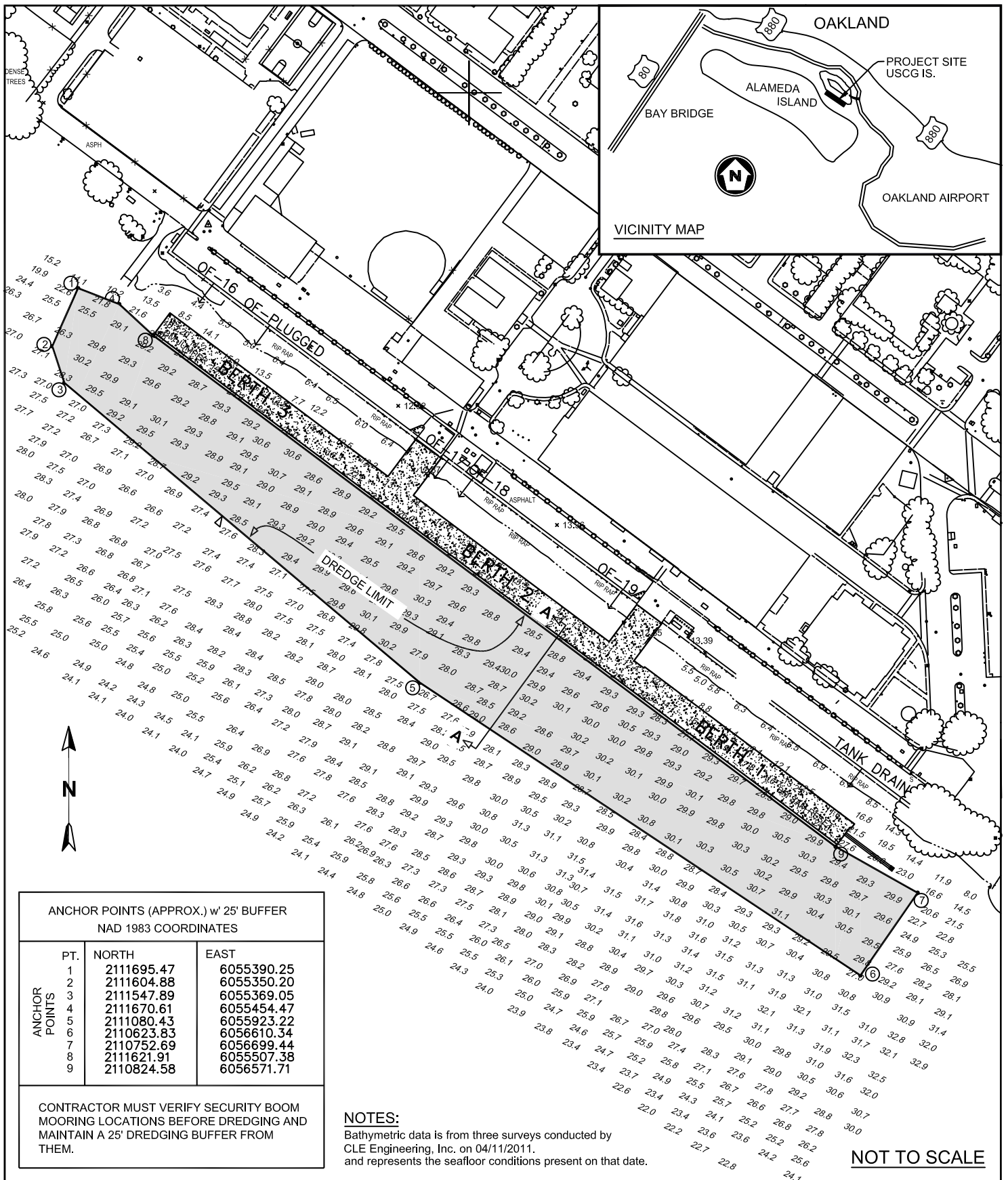

ANCHOR POINTS (APPROX.) w' 25' BUFFER NAD 1983 COORDINATES		
PT.	NORTH	EAST
1	2111695.47	6055390.25
2	2111604.88	6055350.20
3	2111547.89	6055369.05
4	2111670.61	6055454.47
5	2111080.43	6055923.22
6	2110623.83	6056610.34
7	2110752.69	6056699.44
8	2111621.91	6055507.38
9	2110824.58	6056571.71

CONTRACTOR MUST VERIFY SECURITY BOOM MOORING LOCATIONS BEFORE DREDGING AND MAINTAIN A 25' DREDGING BUFFER FROM THEM.

NOTES:
 Bathymetric data is from three surveys conducted by CLE Engineering, Inc. on 04/11/2011, and represents the seafloor conditions present on that date.

NOT TO SCALE

PURPOSE: BERTH DREDGING

DATUM: MLLW

CORPS FILE NUMBER: 2012-00356S

PROJECT SITE PLAN

BERTH DREDGING

USCG BASE ALAMEDA
 COAST GUARD ISLAND
 ALAMEDA, CALIFORNIA

BERTH DREDGING

IN: ALAMEDA

AT: USCG BASE ALAMEDA

COUNTY OF: ALAMEDA **STATE:** CA

APPLICATION BY: USCG

SHEET: 3 OF 4 **DATE:** 13 FEB 2015

USCG BASE ALAMEDA TYPICAL SECTION A - A

VIEW LOOKING NORTHWEST
SCALE: NONE

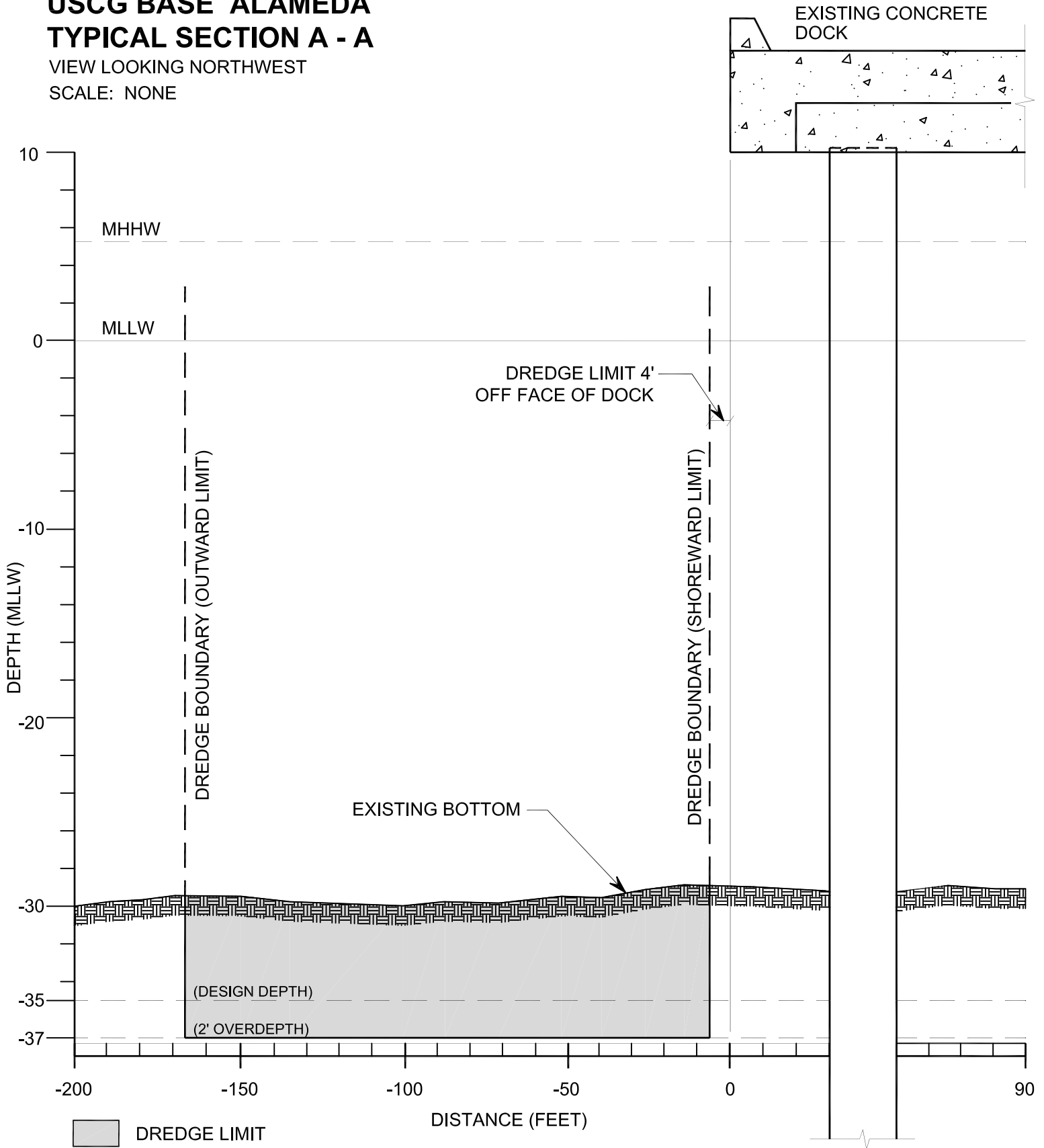

PURPOSE: BERTH DREDGING

DATUM: MLLW

CORPS FILE NUMBER: 2012-00356S

TYPICAL CROSS SECTION

BERTH DREDGING

USCG BASE ALAMEDA
COAST GUARD ISLAND
ALAMEDA, CALIFORNIA

BERTH DREDGING

IN: ALAMEDA

AT: USCG BASE ALAMEDA

COUNTY OF: ALAMEDA **STATE:** CA

APPLICATION BY: USCG

SHEET: 4 OF 4 **DATE:** 13 FEB 2015