

11/12/2015 4:10 PM CUSTOMER ENGINEERING SHALL NOT BE RESPONSIBLE FOR THE ACCURACY OR COMPLETENESS OF THIS PLAN SHEET.

S:\4195_CCHD_10_year_aradag_permit\dwg\2015\1103 -- 4195_CCHD -- VICINITY_MAP.dwg

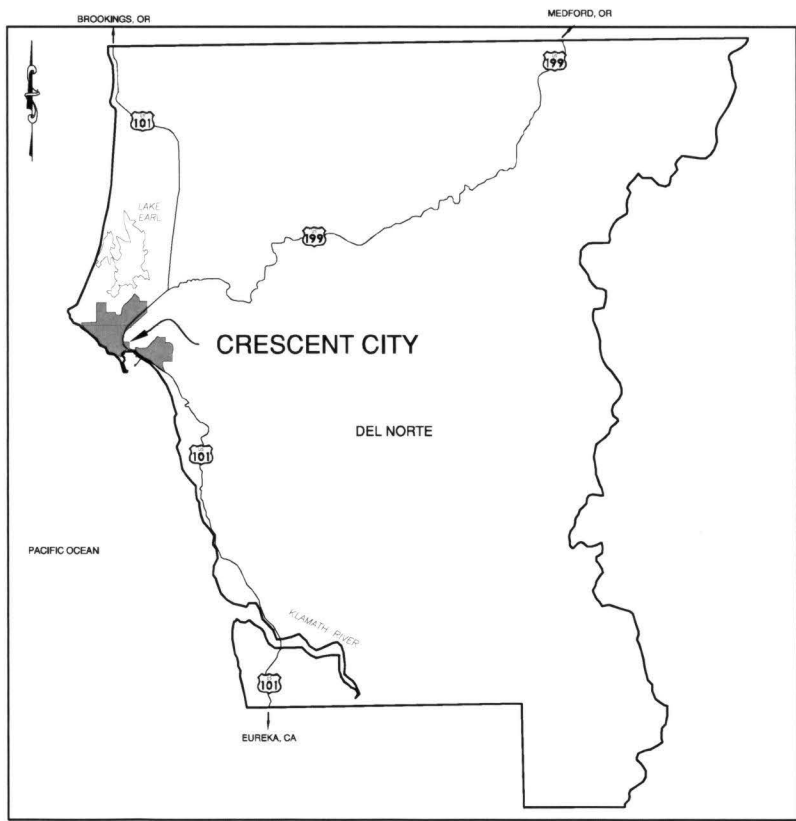

STATE MAP
NTS



DEL NORTE COUNTY
NTS

USACE file: 2011-00389N
Crescent City Harbor
Maintenance Dredging

Sheet 1 of 6
November 2015

STOVER ENGINEERING
Civil Engineers and Consultants
PO BOX 783 - 711 H STREET
CRESCENT CITY, CA 95531 - 707-465-6742

CRESCENT CITY HARBOR DISTRICT
CRESCENT CITY, CA

VICINITY MAP

ONE INCH NTS

FIGURE 1.0

11/12/2015 4:12 PM STOVER ENGINEERING SHALL NOT BE RESPONSIBLE FOR THE ACCURACY OR COMPLETENESS OF ELECTRONIC COPIES OF THIS PLAN SHEET.

S:\4195_CCHD_10_year_dredge_permit\dwg\20151103_4195_CCHD - DREDGE AREAS.dwg

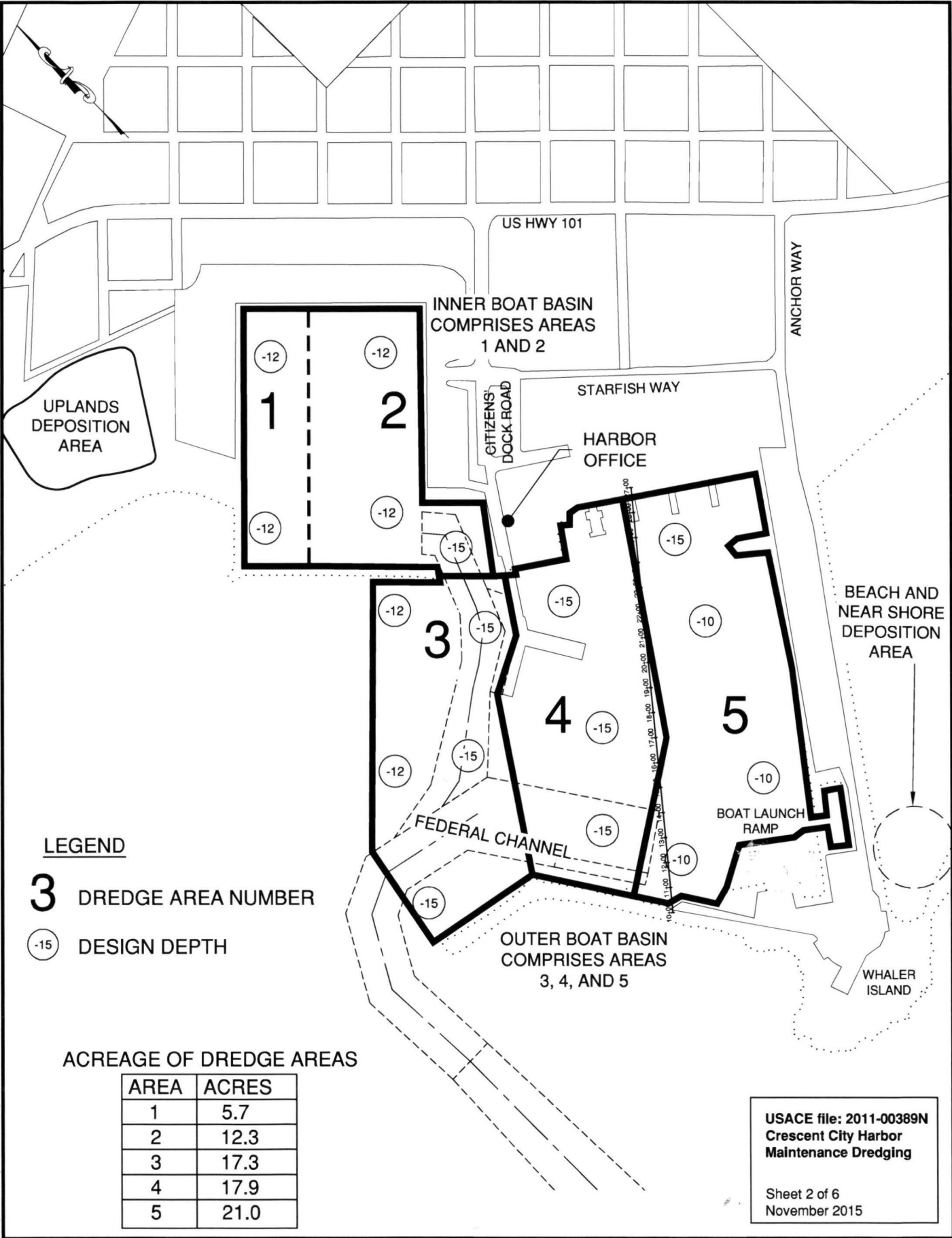

LEGEND

- 3** DREDGE AREA NUMBER
- (-15) DESIGN DEPTH

ACREAGE OF DREDGE AREAS

AREA	ACRES
1	5.7
2	12.3
3	17.3
4	17.9
5	21.0

USACE file: 2011-00389N
 Crescent City Harbor
 Maintenance Dredging
 Sheet 2 of 6
 November 2015

STOVER ENGINEERING
 Civil Engineers and Consultants
 PO BOX 783 - 711 H STREET
 CRESCENT CITY, CA 95531 - 707-465-6742

CRESCENT CITY HARBOR DISTRICT
 CRESCENT CITY, CA

DREDGE AREAS

ONE INCH = 500'

FIGURE 2.0

11/12/2015 4:13 PM STOVER ENGINEERING SHALL NOT BE RESPONSIBLE FOR THE ACCURACY OR COMPLETENESS OF ELECTRONIC COPIES OF THIS PLAN SHEET.

S:\4195_CCHD_10-year_dredge_permit\dwg\2015\103_4195_CCHD_DREDGE_AREAS.dwg

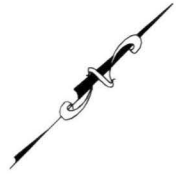

UPLANDS DEPOSITION AREA

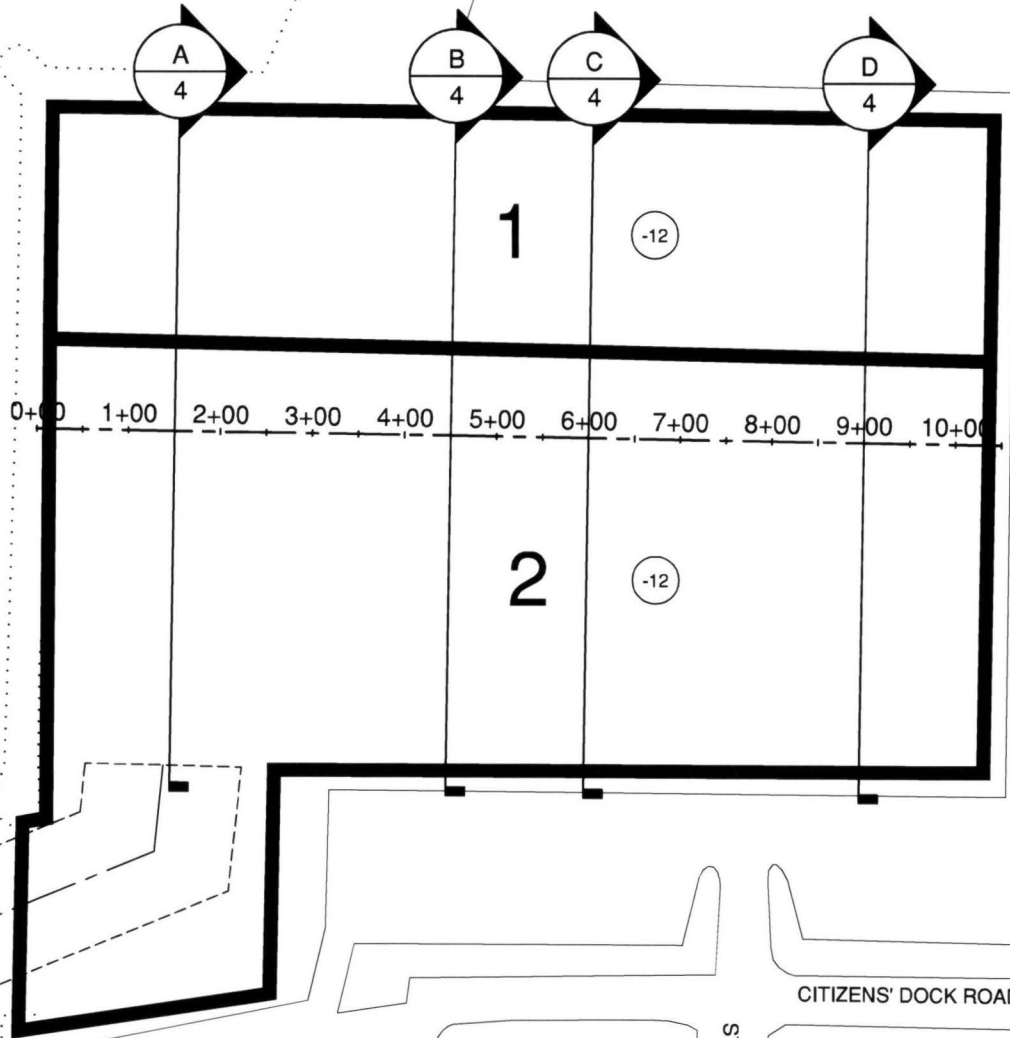

LEGEND

3 DREDGE AREA NUMBER

(-15) DESIGN DEPTH

USACE file: 2011-00389N
Crescent City Harbor
Maintenance Dredging

Sheet 3 of 6
November 2015

STOVER ENGINEERING
Civil Engineers and Consultants
PO BOX 783 - 711 H STREET
CRESCENT CITY, CA 95531 - 707-465-6742

CRESCENT CITY HARBOR DISTRICT
CRESCENT CITY, CA

INNER BASIN - DREDGE AREAS

ONE INCH 1"=200'

FIGURE 3.0

11/12/2015 4:16 PM:STOVER ENGINEERING SHALL NOT BE RESPONSIBLE FOR THE ACCURACY OR COMPLETENESS OF THIS PLAN SHEET.

S:\4156_CCHD_10_year_dredge_permits\dwg\2015\1103 - 4156_CCHD - INNER BASIN SECTIONS.dwg

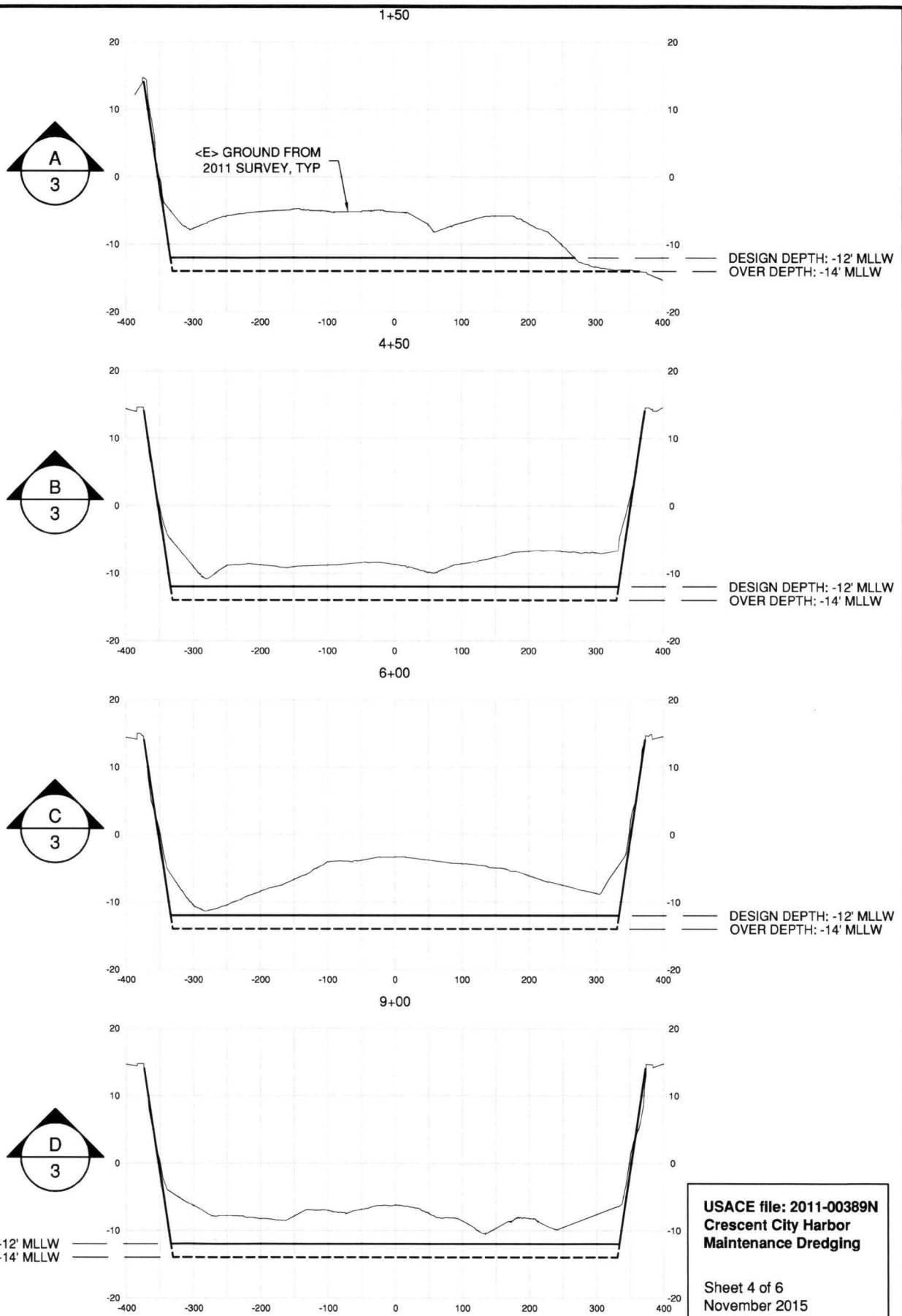

STOVER ENGINEERING
Civil Engineers and Consultants
PO BOX 783 - 711 H STREET
CRESCENT CITY, CA 95531 - 707-465-6742

CRESCENT CITY HARBOR DISTRICT
CRESCENT CITY, CA

INNER BASIN - SECTIONS

ONE INCH = 200'

FIGURE 4.0

11/12/2015 4:14 PM TOVER ENGINEERING SHALL NOT BE RESPONSIBLE FOR THE ACCURACY OR COMPLETENESS OF ELECTRONIC COPIES OF THIS PLAN SHEET.

S:\4195_CCHD_10_year_dredge_permit\dwg\20151103_4195_CCHD - DREDGE ART.dwg

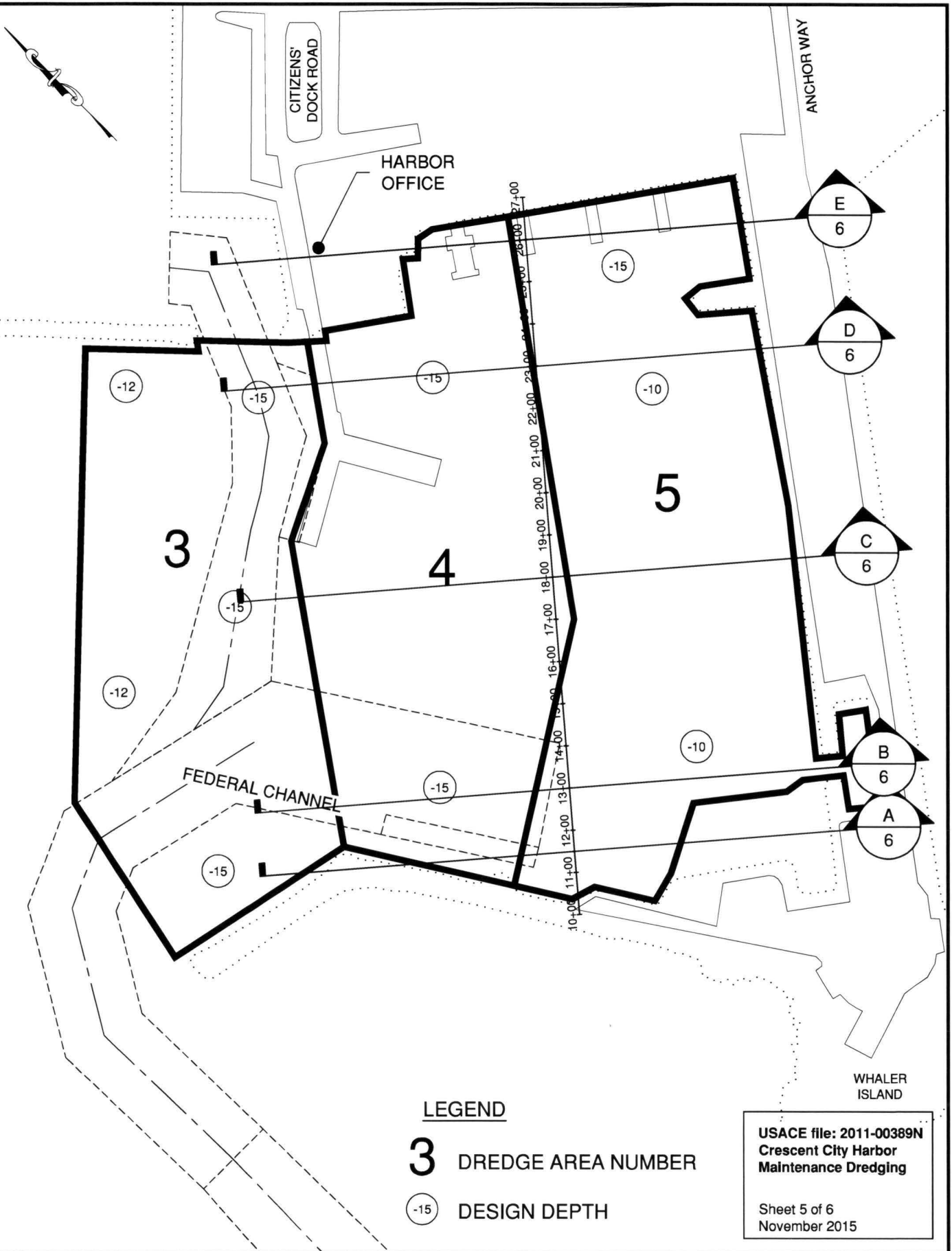

LEGEND

3 DREDGE AREA NUMBER

(-15) DESIGN DEPTH

USACE file: 2011-00389N
Crescent City Harbor
Maintenance Dredging

Sheet 5 of 6
November 2015

STOVER ENGINEERING
Civil Engineers and Consultants
PO BOX 783 - 711 H STREET
CRESCENT CITY, CA 95531 - 707-465-6742

CRESCENT CITY HARBOR DISTRICT
CRESCENT CITY, CA

OUTER BASIN - DREDGE AREAS

ONE INCH = 300'

FIGURE 5.0

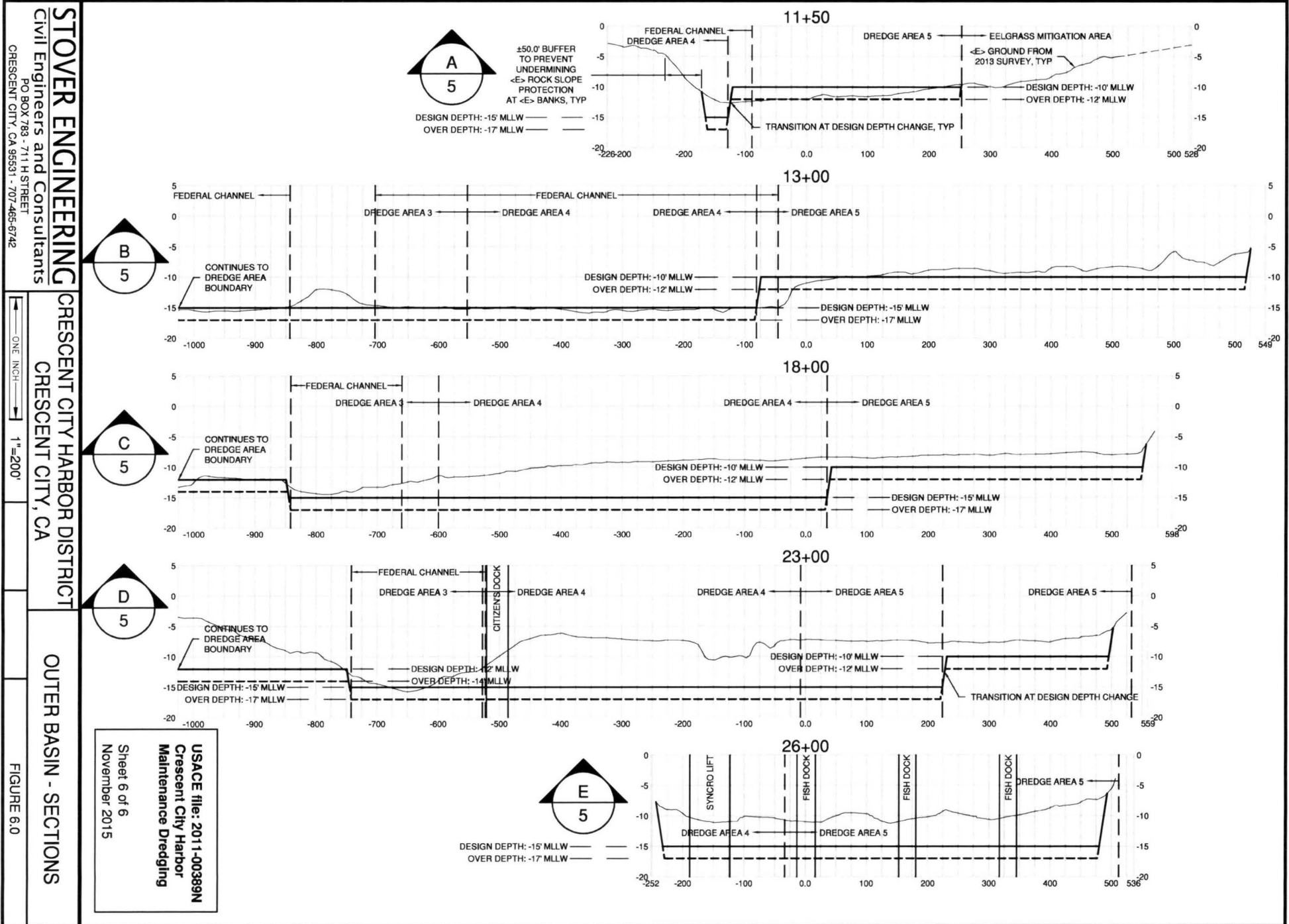

STOVER ENGINEERING
 Civil Engineers and Consultants
 PO BOX 789 - 711 H STREET
 CRESCENT CITY, CA 95531 - 707-465-6742

CRESCENT CITY HARBOR DISTRICT
 CRESCENT CITY, CA

OUTER BASIN - SECTIONS

ONE INCH = 1" = 200'

FIGURE 6.0

USACE file: 2011-00389N
 Crescent City Harbor
 Maintenance Dredging

Sheet 6 of 6
 November 2015