

K:\U:\GIS\USCG_Humboldt_Bay\Projects\elgrass_memo\Fig1_USCG_HumboldtBay_site.mxd 7/9/2012 2:04:30 PM

Source: USGS 7.5' Topographic Series; Eureka, Fields Landing Quadrangles.

Applicant: U.S. Coast Guard
 Project: USCG Station Humboldt Bay Maintenance Dredging
 Location: Eureka, Humboldt County, CA
 Corps File No.: 2013-00093N
 Date: March 2, 2016

Sheet 1 of 5



Project Vicinity

USCG STATION HUMBOLDT BAY

Maintenance Dredging at
 USCG Station Humboldt Bay
 Humboldt County, California

28068026

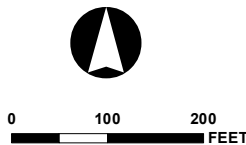

FIGURE 1



- Eelgrass Survey Features
- Mean Higher High Water
- Mean Lower Low Water
- Dredge Area
- Barrier*
- Stone Revetment*
- Existing Wall

*proposed under a separate project



PROJECT FEATURES

Maintenance Dredging at
 USCG Station Humboldt Bay
 Humboldt County, California

FIGURE 2

NGS
TIDAL 11
SET 1998
EL=13.97
MLLW

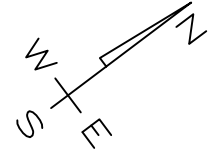

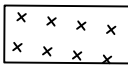
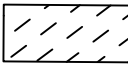
-  Dredge Template to -8ft MLLW
-  Dredge Template to -10ft MLLW



● PILES ●

TIDEBOARD

PIER

DOLPHIN

PIER

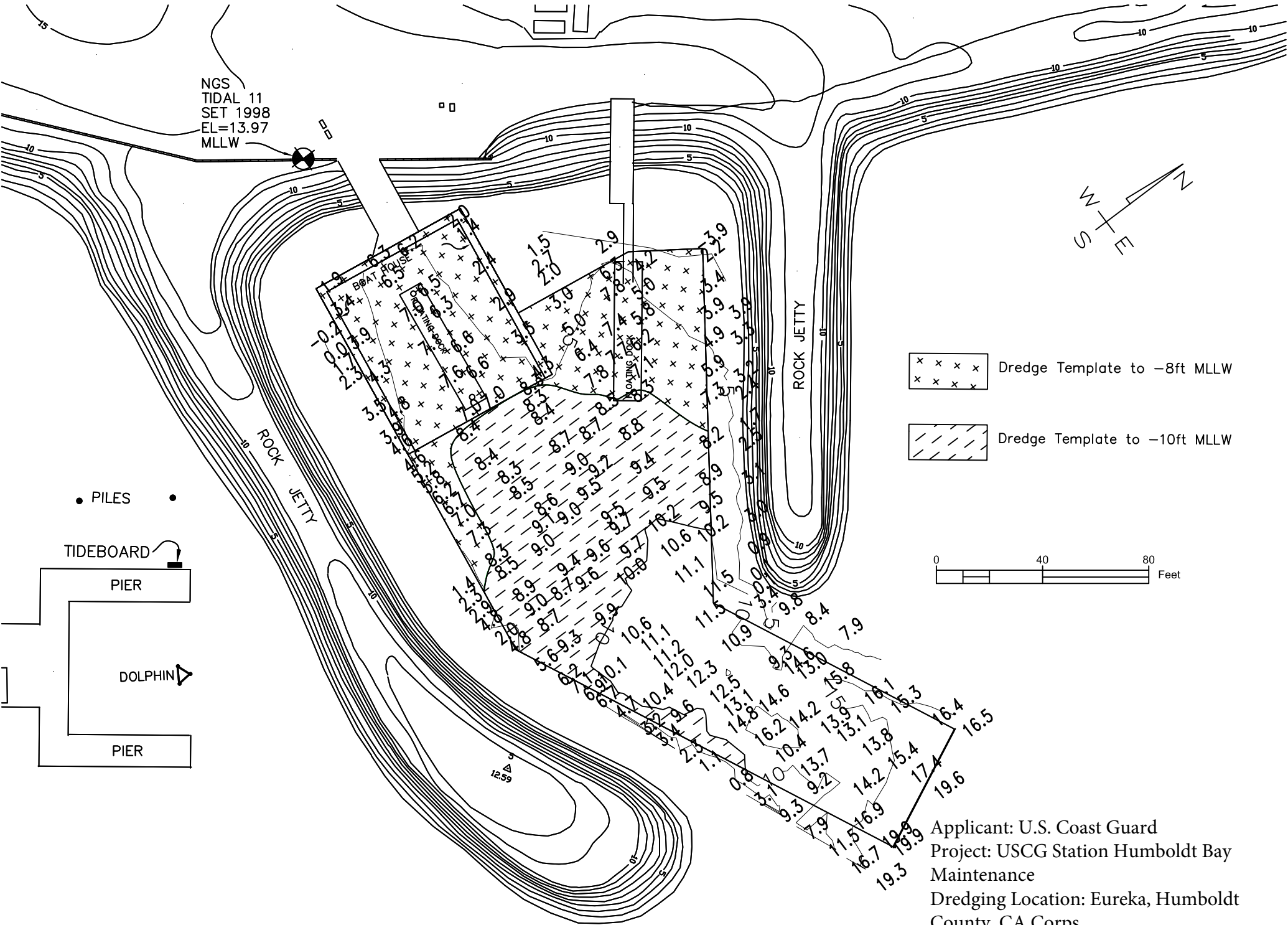

Applicant: U.S. Coast Guard
 Project: USCG Station Humboldt Bay
 Maintenance
 Dredging Location: Eureka, Humboldt
 County, CA Corps
 File No.: 2013-00093N
 Date: March 2, 2016

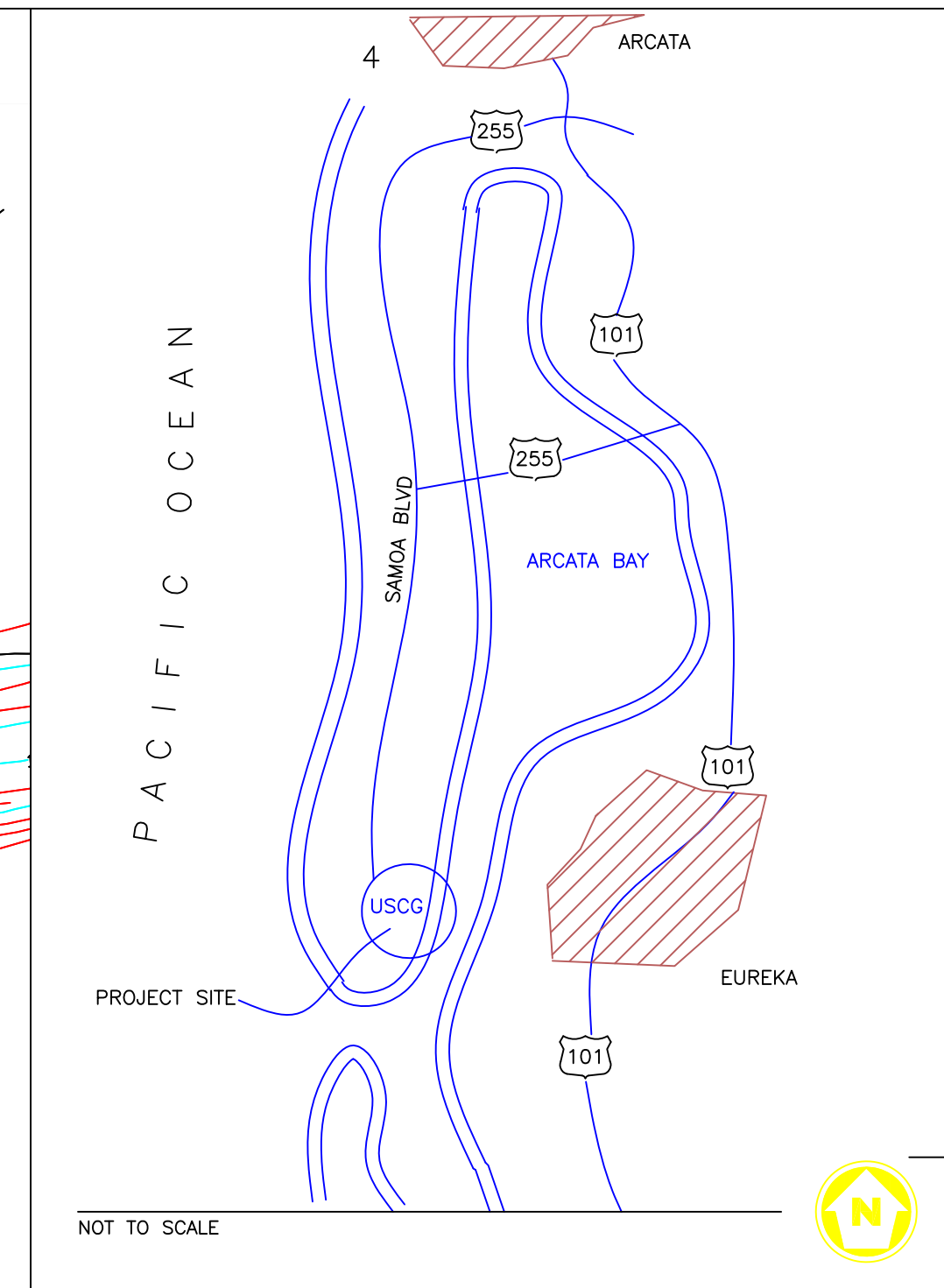
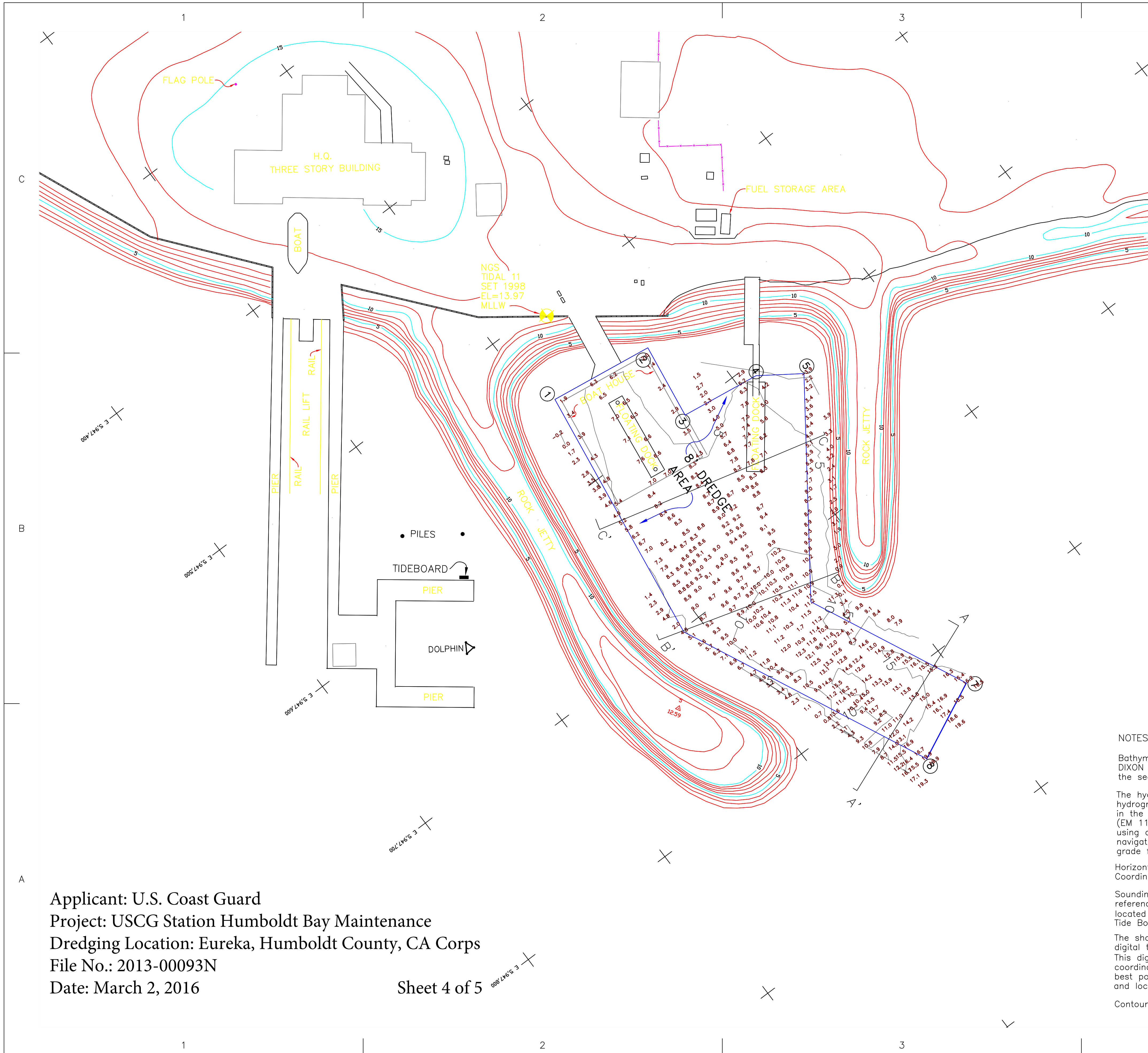

DREDGE BOUNDARY NAD 1983 COORDINATES		
PT.	NORTH	EAST
1	2170409.61	5947547.71
2	2170471.17	5947556.31
3	2170464.90	5947600.87
4	2170511.90	5947607.43
5	2170535.00	5947623.26
6	2170457.88	5947732.32
7	2170501.82	5947824.88
8	2170456.69	5947846.32
9	2170387.96	5947701.66

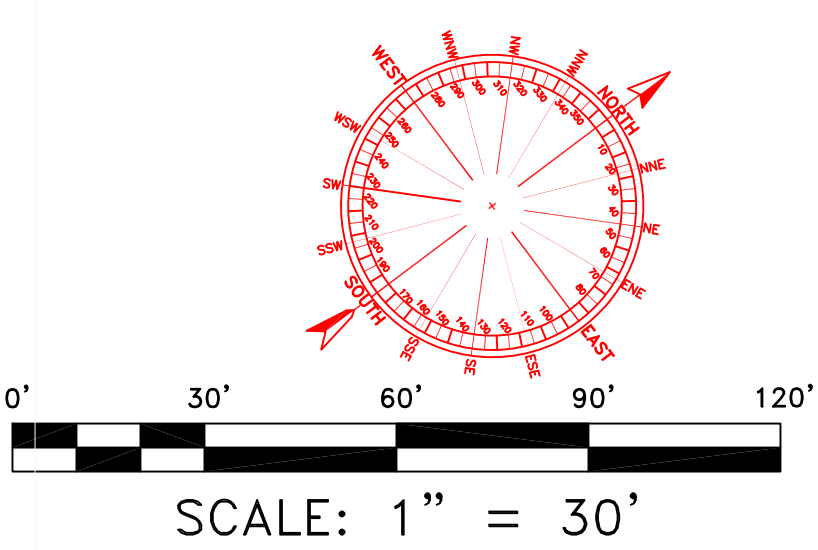

NOTES:

Bathymetric data is from a survey conducted by DIXON MARINE SERVICES, Inc. on 26 OCTOBER 2011 and represents the seafloor conditions present on that date.

The hydrographic survey was conducted using Class 1 hydrographic survey methods and accuracies outlined in the Corps of Engineers' HYDROGRAPHIC SURVEYING MANUAL (EM 1110-2-1003, January 2002). The survey was performed using a 24' survey boat, a VS 110 DGPS navigation system, and ODOM CV-100 survey grade fathometer, and tide gauge.

Horizontal datum is based on the California State Plane Coordinate System, Zone 1 (NAD 1983).

Soundings are in feet below Mean Lower Low Water (MLLW), as referenced to NGS benchmark "Tidal 11" 1998 (EI = 13.97' MLLW) located at US Coast Guard Station bulk head wall. Tide Board set at 0.0 MLLW on dolphin pile as indicated.

The shoreline features shown on this chart are from a digital topographic map provided by Western Aerial. This digital map was not referenced to an established coordinate system. The digital map was altered to provide the best possible fit to the hydrographic data. The shoreline features, and location of docks, piers, and slips may not be accurate.

Contours are generated every 5 feet.

DIXON MARINE SERVICES, INC.
 12786 Sir Francis Drake Blvd.
 Inverness, CA 94937
 Office: 415.669.7369
 FAX 415.669.7409

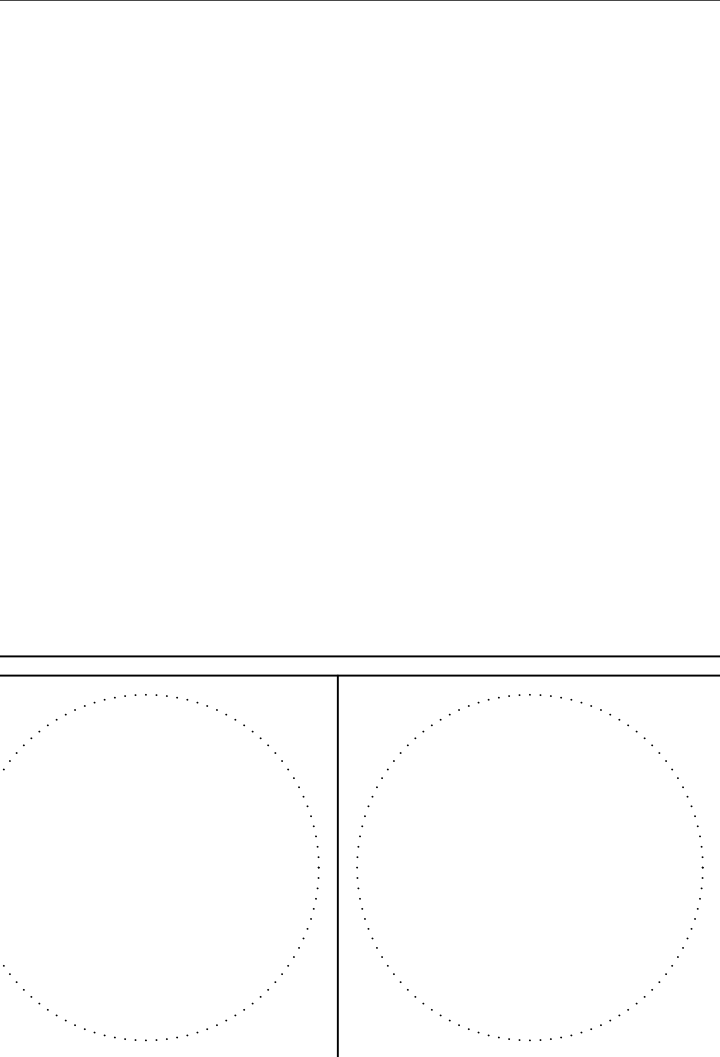

U. S. Coast Guard
 Civil Engineering Unit
 Oakland, CA

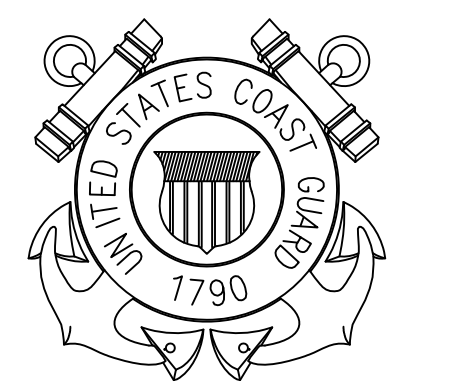

USCG, CEU Oakland
 2000 Embarcadero Suite 200
 Oakland, CA 94606-5337

ISSUE		
MARK	DATE	DESCRIPTION
DMS	10/26/11	Conditional

A/E PROJECT NO: WO	CAD FILE NAME: 03041HUMBOLDT
DESIGNED BY: ENG	DRAWN BY: KEVIN_TWEED
EDITED BY: -	CHECKED BY: ELI_DESHAIES
SCALE: 1"=30'	PLOT SCALE: 1"=1'

SHEET TITLE

U.S. Coast Guard
 Station Humboldt Bay
 Eureka California

Civil
 Conditional
 HYDROGRAPHIC SURVEY

REVIEWED BY:	REVIEWED BY:	REVIEWED BY:
PROJECT ENG.	BRANCH CHIEF	CONTRACTING CO
APPROVING OFFICER		DATE
PROJECT NUMBER	DRAWING NUMBER	
HUMB	HUMBOLDT	
DISCIPLINE/SHT NO	Sheet 1 of 2	
CIVIL		

Applicant: U.S. Coast Guard
 Project: USCG Station Humboldt Bay Maintenance
 Dredging Location: Eureka, Humboldt County, CA Corps
 File No.: 2013-00093N
 Date: March 2, 2016

See Plan View For Section Locations

Applicant: U.S. Coast Guard
 Project: USCG Station Humboldt Bay Maintenance
 Dredging Location: Eureka, Humboldt County, CA
 Corps File No.: 2013-00093N
 Date: March 2, 2016

Sheet 5 of 5

DIXON MARINE SERVICES, INC.
 12786 Sir Francis Drake Blvd.
 Inverness, CA 94937
 Office: 415.669.7369
 FAX 415.669.7409

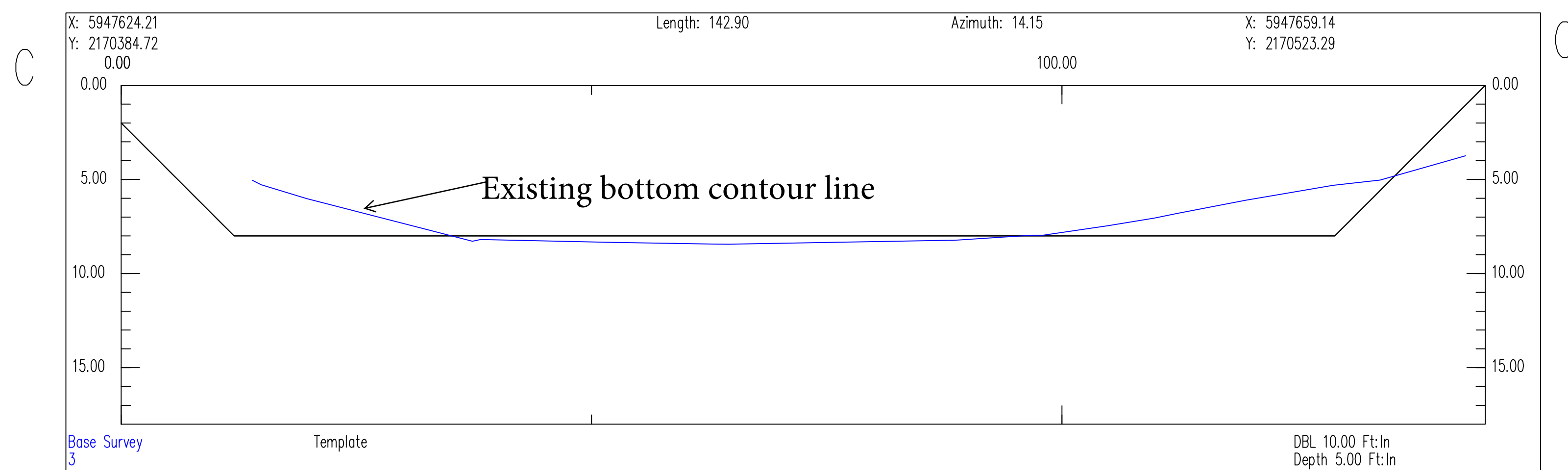
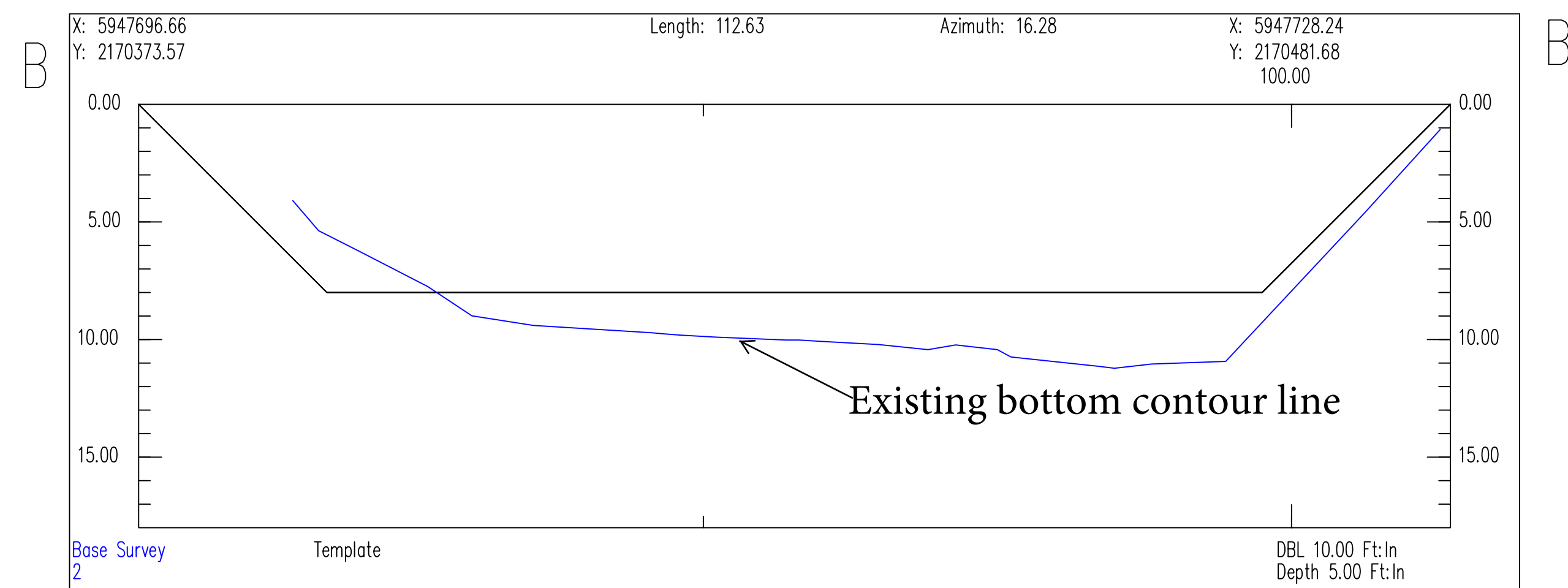
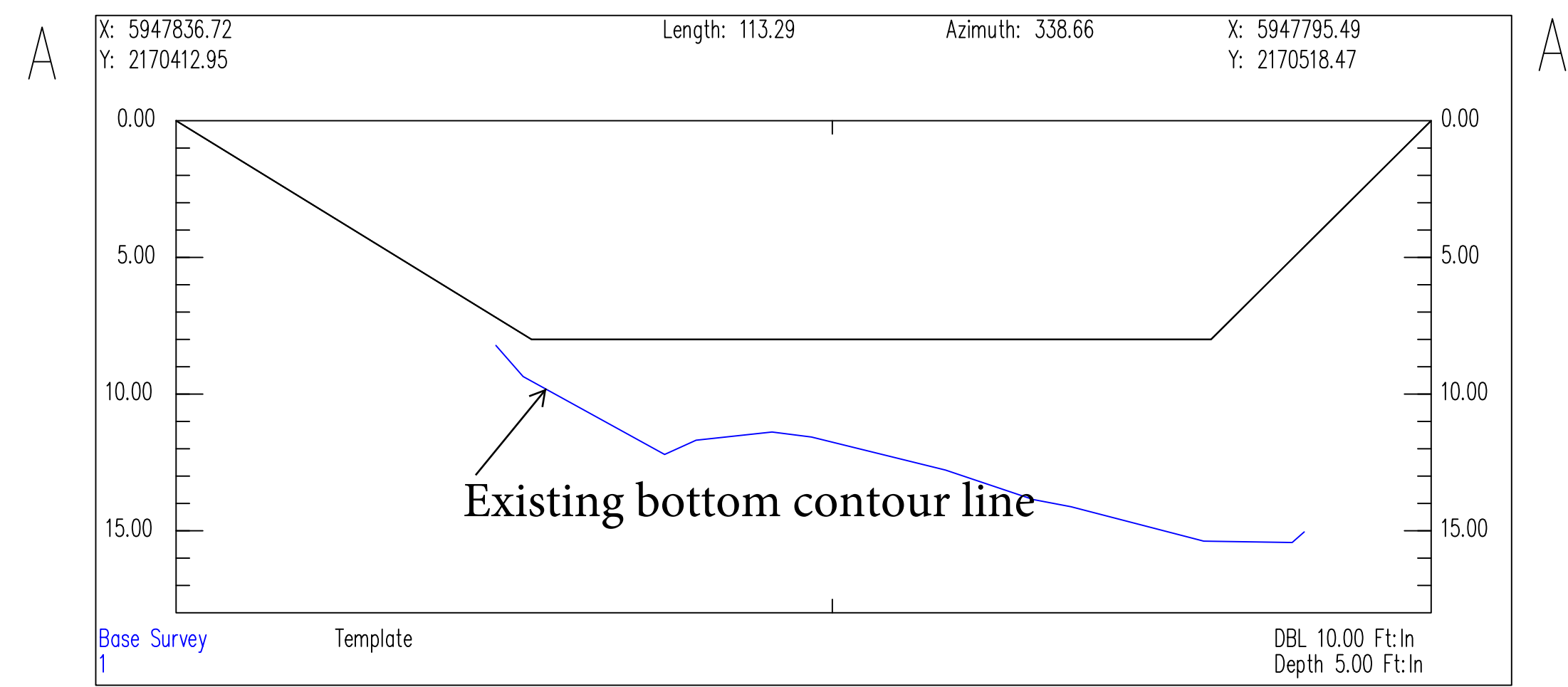

Scale: Horizontal 1"=10'
 Depth 1"=5'

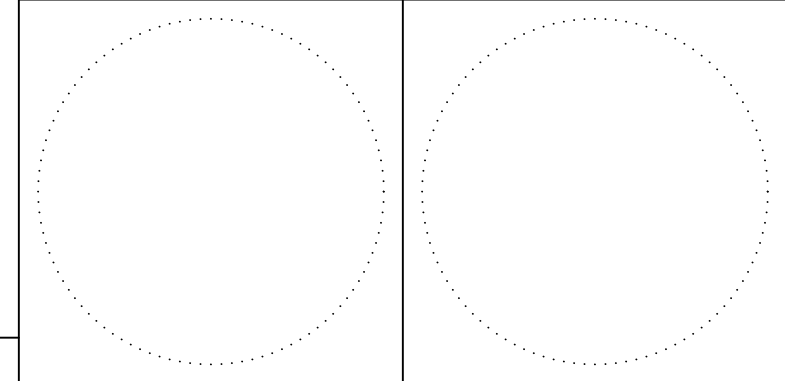

U. S. Coast Guard
 Civil Engineering Unit
 Oakland, CA

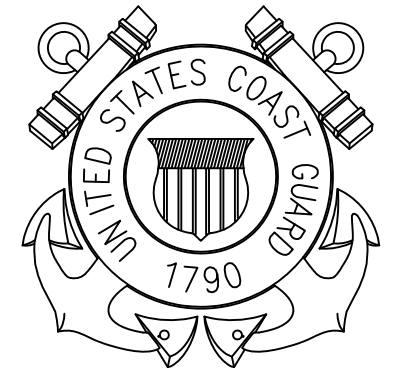

USCG, CEU Oakland
 2000 Embarcadero Suite 200
 Oakland, CA 94606-5337

ISSUE		
MARK	DATE	DESCRIPTION
DMS	10-26-11	Conditional

A/E PROJECT NO: WO
 CAD FILE NAME: 03041HUMBOLDT
 DESIGNED BY: ENG
 DRAWN BY: KEVIN_TWEED
 EDITED BY: -
 CHECKED BY: ELI_DESHAIES

SCALE: As Noted PLOT SCALE: 1"=1'

SHEET TITLE

U.S. Coast Guard
 Station Humboldt Bay
 Eureka California
 Civil
 Conditional
 HYDROGRAPHIC SURVEY

REVIEWED BY:	REVIEWED BY:	REVIEWED BY:
PROJECT ENG.	BRANCH CHIEF	CONTRACTING CO

APPROVING OFFICER	DATE
-------------------	------

PROJECT NUMBER	DRAWING NUMBER
HUMB	HUMBOLDT
DISCIPLINE/SHT NO	Sheet 2 of 2
CIVIL	