

6,051,500  
W 122° 16' 20"

N 38° 04' 00"

2,215,400

2,214,400

N 38° 03' 40"

2,213,400

6,051,500  
W 122° 16' 20"

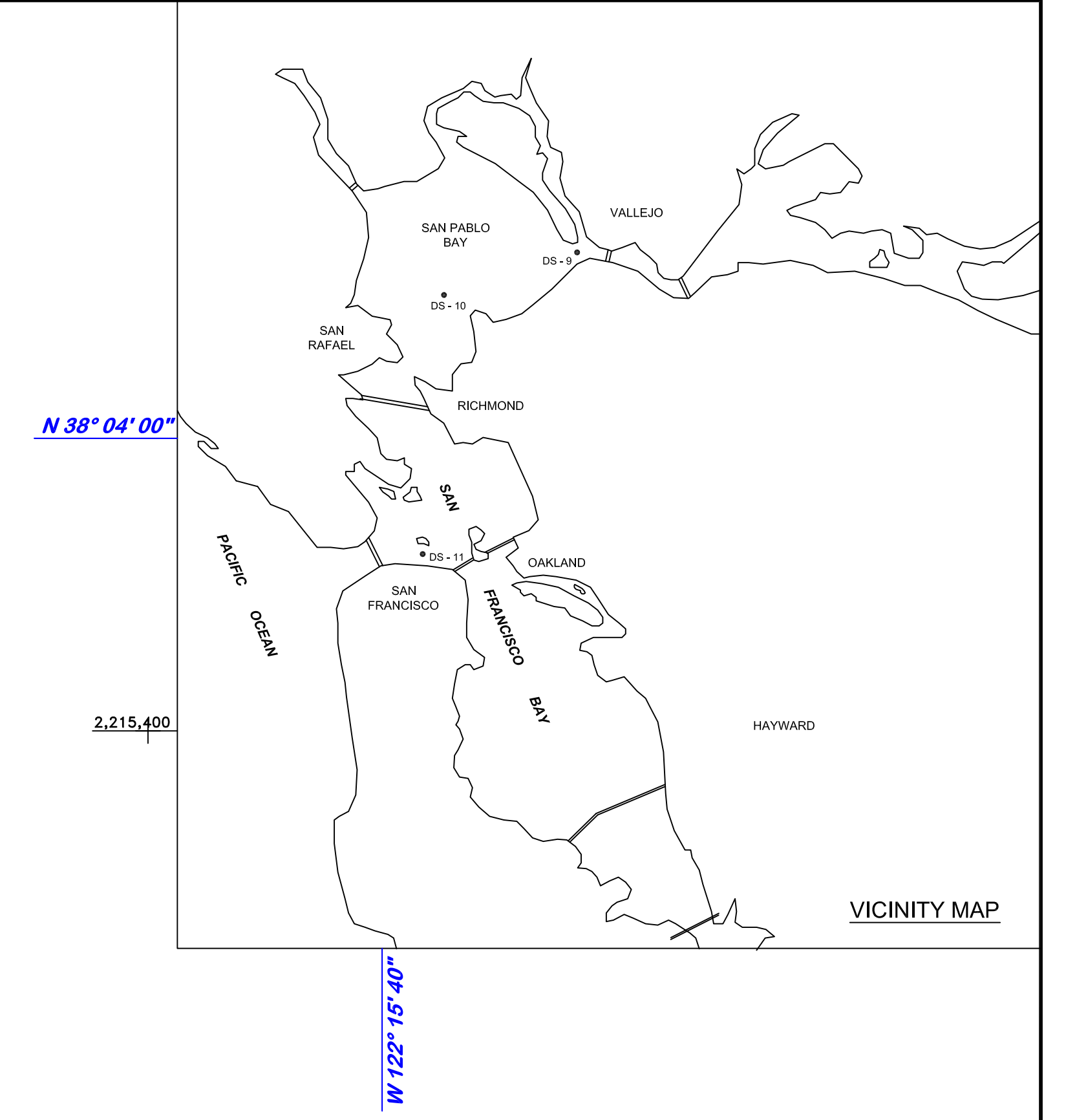
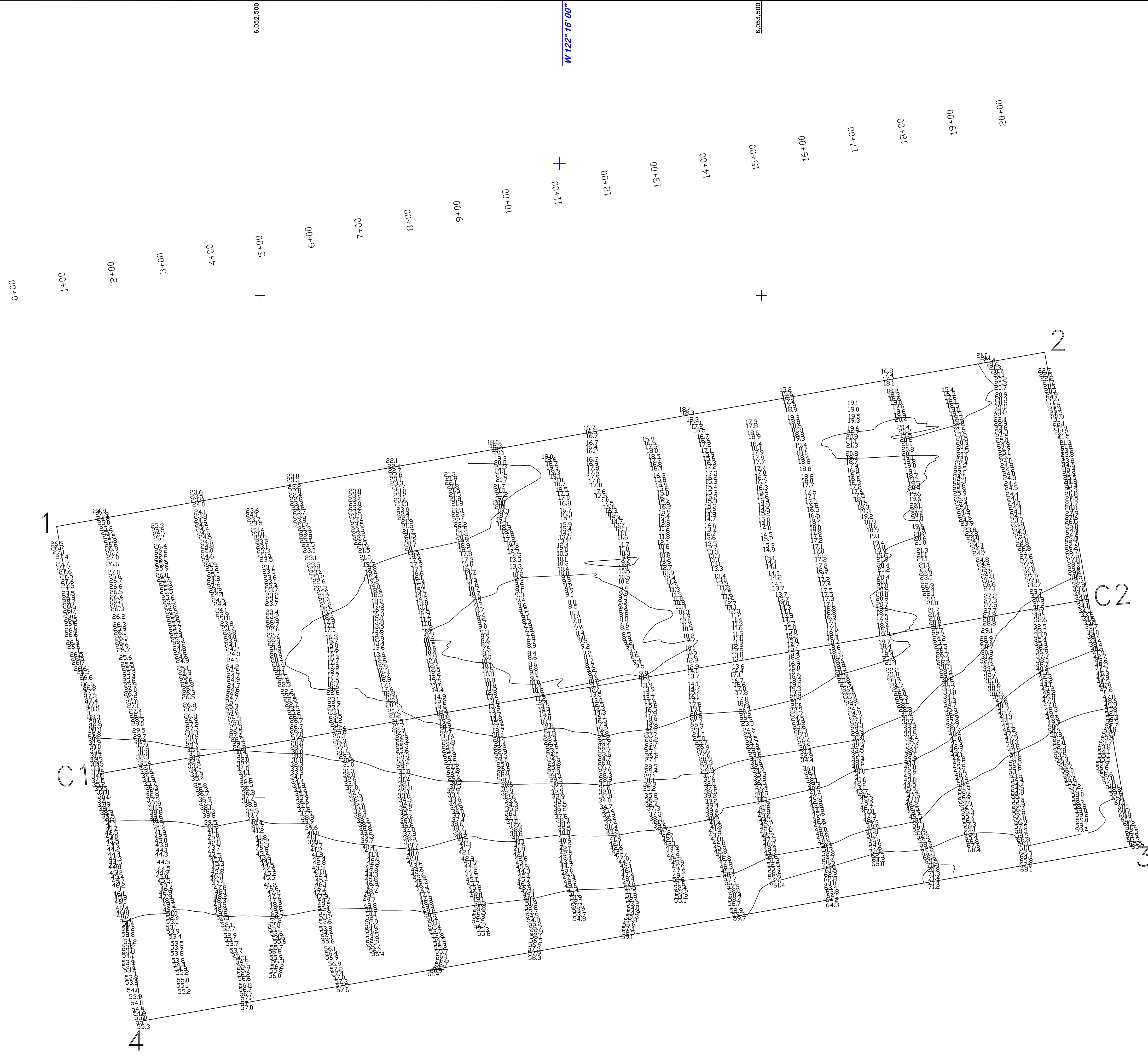
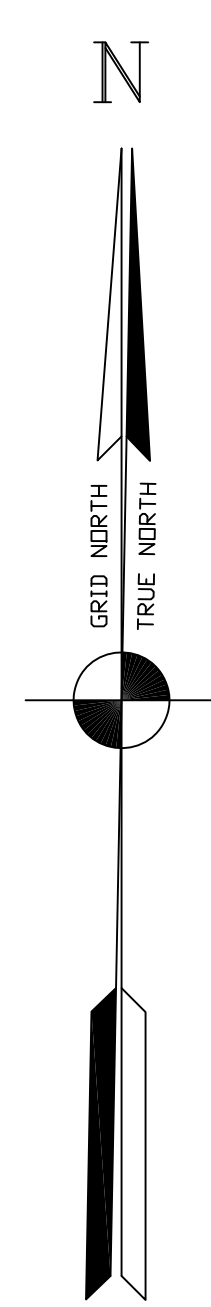

N 38° 04' 00"

2,215,400

W 122° 15' 40"

VICINITY MAP

**COORDINATES CHART**

| CHANNEL PT. | X            | Y            |
|-------------|--------------|--------------|
| 1           | 6052094.6100 | 2214939.5300 |
| 2           | 6054064.3100 | 2215286.8300 |
| 3           | 6054237.9100 | 2214302.0300 |
| 4           | 6052268.3100 | 2213954.7300 |

| CENTERLINE PT. | X            | Y            |
|----------------|--------------|--------------|
| C1             | 6052181.5100 | 2214447.1300 |
| C2             | 6054151.1100 | 2214794.4300 |

**PRELIMINARY ISSUE**  
THIS PLAN ISSUED FOR  
ADVANCE INFORMATION ONLY

**NOTES:**

DRAWINGS NOT TO BE USED AS NAVIGATION CHART. ONLY CHANNEL CONDITION AT DATE OF SURVEY. THE LOCATION OF ALL NAVIGATION AIDS ARE BASED ON INFORMATION PROVIDED BY THE U.S. COAST GUARD BUOY LOCATIONS REPRESENT THE POSITION OF THE SINKER ONLY.

SURVEYED BY THE CORPS OF ENGINEERS.

SOUNDINGS ARE TAKEN BY FATHOMETER AND ARE SHOWN TO THE NEAREST FOOT AND TENTHS OF A FOOT.

SOUNDINGS ARE BASED ON THE DATUM OF MEAN LOWER LOW WATER AT THE LOCALITY.

PLANE GRID, BEARING AND COORDINATES ARE BASED ON THE STATE OF CALIFORNIA COORDINATE SYSTEM, LAMBERT CONFORMAL PROJECTION, ZONE III NAD 83, CALIFORNIA, AS DESCRIBED IN SPECIAL PUBLICATION NO. 253, PUBLISHED BY NATIONAL OCEAN SURVEY.

THE PROJECT DEPTH IS 50 FEET AT M.L.L.W.

SOUNDINGS ARE BASED ON THE TIDE GAUGE LOCATED AT MARE ISLAND COAST GUARD DOCK VERTICAL CONTROL U-466 1950 USC&GS DISK ELEV. 13.99 FT MLLW TIDAL 5278 USC&GS DISK ELEV. 11.04 FT MLLW HORIZONTAL CONTROL COAST GUARD D-BEACON

|   |  |   |  |                  |  |
|---|--|---|--|------------------|--|
| DRAWN BY: PDT   |  | SOLANO-CONTRA COSTA COUNTY  |  | CALIFORNIA       |  |
| CHECKED BY: PDT   |  | <b>CARQUINEZ STRAIT</b><br>CONDITION SURVEY<br>DISPOSAL SITE SF NO. 9<br>10 JULY 2012 |  |                  |  |
| DESIGNED BY:  |  |   |  |                  |  |
| SUBMITTED: PDT  |  |   |  |                  |  |
| APPROVAL RECOMMENDED:   |  | APPROVED:   |  | DATE:            |  |
| CHIEF, GEOMATICS SECTION  |  | CHIEF, CONSTRUCTION BRANCH  |  | SCALE: 1" = 100' |  |
| PREPARED UNDER THE DIRECTION OF<br>LT. COLONEL, C.E., DISTRICT ENGINEER |  | JOB NO.:  |  | DRAWING NUMBER   |  |
| SHEET: 1 OF 1   |  | 51  |  | 2                |  |