

PRELIMINARY ISSUE  
THIS PLAN ISSUED FOR  
ADVANCE INFORMATION ONLY

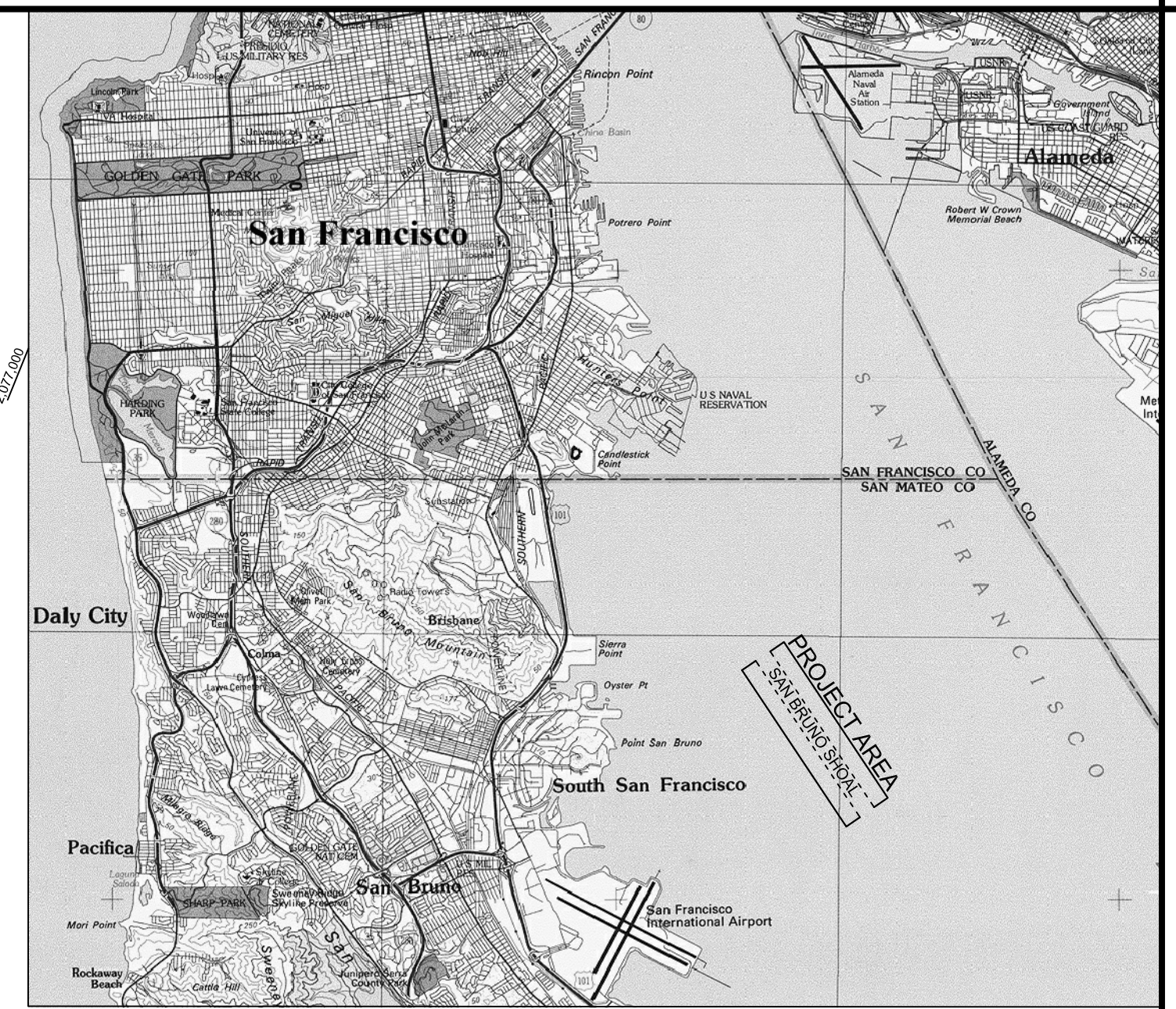

VICINITY MAP  
NOT TO SCALE

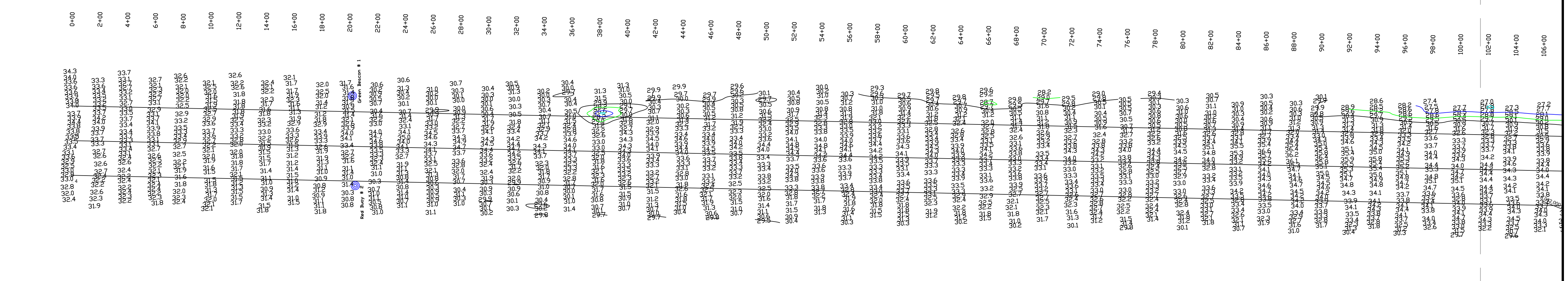

CHANNEL ANGLE POINTS NAD 1983		
CHANNEL ∠	EAST	NORTH
1	6028665.8184	2082886.0402
2	6039323.8184	2054933.0402
3	6038856.6184	2054749.9402
4	6028198.6184	2082707.9402

CENTERLINE ANGLE POINTS NAD 1983		
CENTERLINE ∠	EAST	NORTH
C1	6028432.2184	2082797.0402
C2	6039090.2184	2054839.0402

**NOTES:**

DRAWING NOT TO BE USED AS NAVIGATION CHART ONLY CHANNEL CONDITION AT DATE OF SURVEY THE LOCATION OF ALL NAVIGATION AIDS ARE BASED ON INFORMATION PROVIDED BY THE U.S. COAST GUARD BUOY LOCATIONS REPRESENT THE POSITION OF THE SINKER ONLY.

INFORMATION DEPICTED ON THIS MAP REPRESENTS THE RESULTS OF SURVEYS MADE ON THE DATES INDICATED AND CAN ONLY BE CONSIDERED AS INDICATING THE GENERAL CONDITIONS EXISTING AT THAT TIME.

SURVEYED BY THE CORPS ENGINEERS.

SOUNDINGS ARE TAKEN BY FATHOMETER AND ARE SHOWN TO THE NEAREST FOOT AND TENTHS OF A FOOT.

SOUNDINGS ARE BASED ON THE DATUM OF MEAN LOWER LOW WATER AT THE LOCALITY.

PLANE GRID, BEARING AND COORDINATES ARE BASED ON THE STATE OF CALIFORNIA COORDINATE SYSTEM, LAMBERT CONFORMAL PROJECTION, ZONE III NAD 83, CALIFORNIA, AS DESCRIBED IN SPECIAL PUBLICATION NO. 253, PUBLISHED BY NATIONAL OCEAN SURVEY.

THE PROJECT DEPTH IS 30 FEET AT M.L.L.W.

SOUNDINGS ARE BASED ON THE TIDE GAUGE LOCATED AT THE GYDE STREET PIER, SAN FRANCISCO, CALIFORNIA.

VERTICAL CONTROL  
BENCHMARK "1" (1945) ELEV. 16.36 FT MLLW.  
BENCHMARK "TIDAL BM 4" (1974) ELEV. 11.17 FT MLLW.

TIDE GAUGE LOCATED AT COYOTE PT. MARINA .

HORIZONTAL CONTROL  
COAST GUARD D-BEACON

**SHEET INDEX**

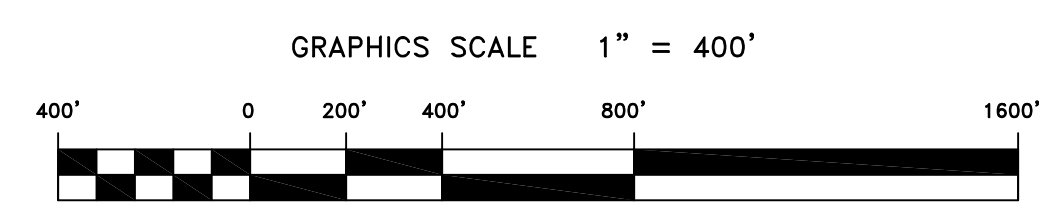
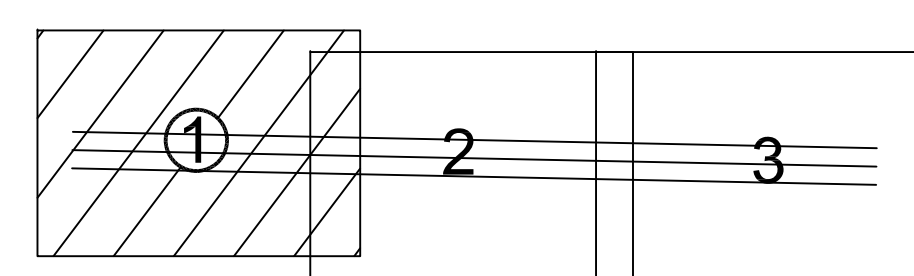

MATCHLINE - SHEET 2

US Army Corps  
of Engineers  
San Francisco District  
1455 Market Street  
San Francisco, CA 94103

Mark	Description	Date	Appr.

DESIGNED BY:	CHECKED BY:	DRAWN BY:
PDT	PDT	PDT
Hydra Survey Team Leader		
APPROVAL:	DATE:	SHEET NO.
Chief, Geomatics Section	06/09/2011	1 OF 3
APPROVAL RECOMMENDED:	PREPARED UNDER THE DIRECTION OF	DRAWING NO.
Chief, Construction Branch	TORREY A. DICIRO	54
	LT. COLONEL, C.E., DISTRICT ENGINEER	2
		XXX

SAN MATEO COUNTY  
CALIFORNIA  
**SAN BRUNO SHOAL**  
CONDITION SURVEY  
6-8 JUNE 2011

Sheet reference number  
**C1**