

PRELIMINARY ISSUE
THIS PLAN ISSUED FOR
ADVANCE INFORMATION ONLY

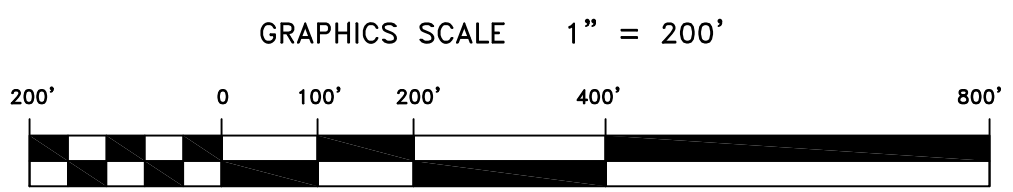
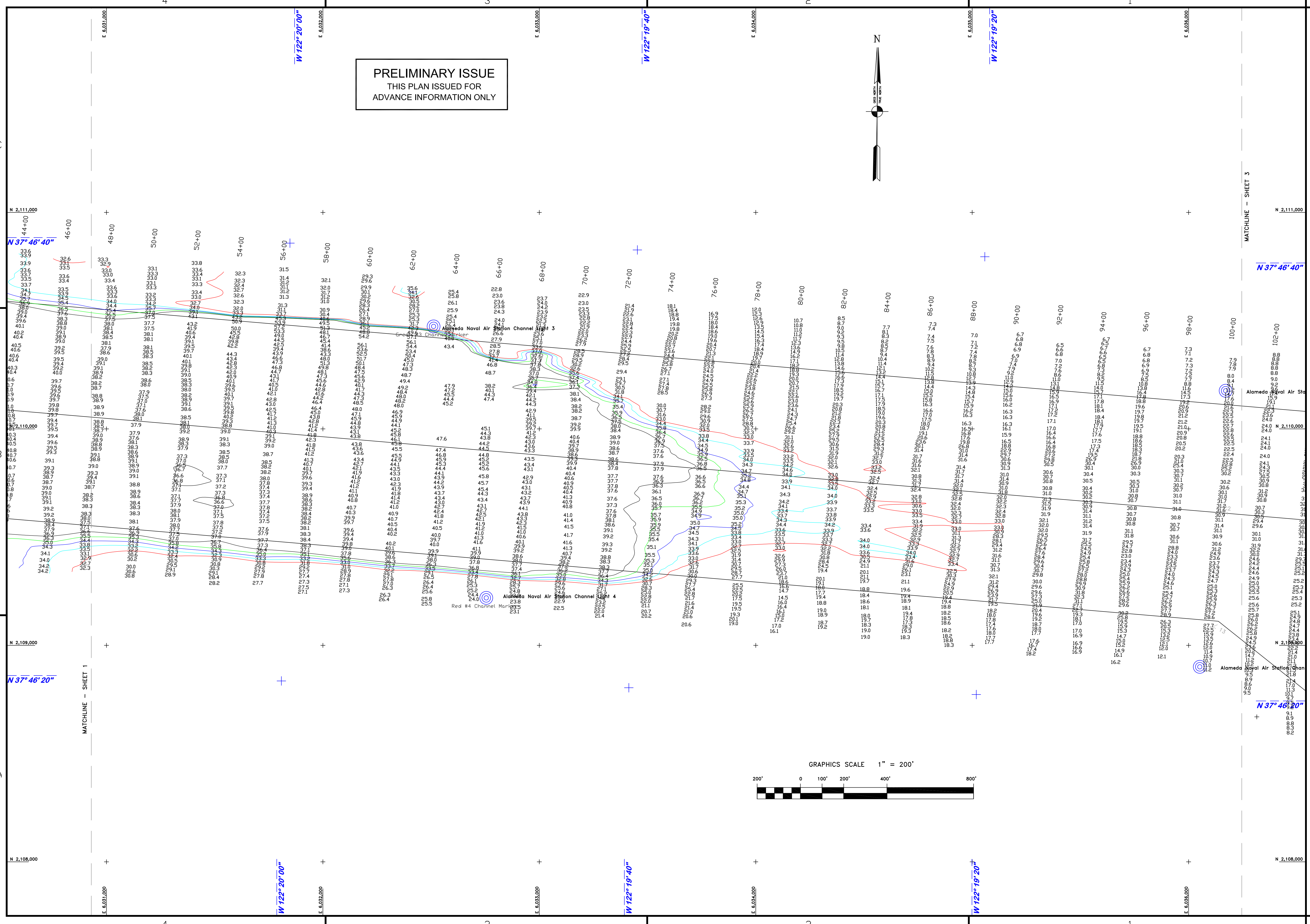
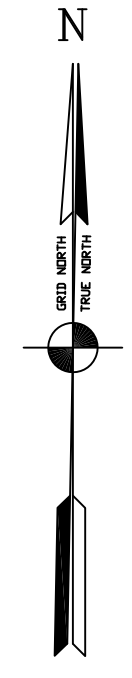

Mark	Description	Date	Appr.

SUBMITTED BY: Hydro Survey Team Leader	PDT	DRAWN BY: PDT
APPROVAL:	SHEET NO. 2 OF 3	DRAWING NO. 2
APPROVAL RECOMMENDED:		PREPARED UNDER THE DIRECTION OF JOHN K. BAKER LT. COLONEL, C.E., DISTRICT ENGINEER

CALIFORNIA
ALAMEDA COUNTY
ALAMEDA NAVAL AIR STATION
CONDITION SURVEY
25 SEPTEMBER 2012

Sheet reference number
C2

US Army Corps of Engineers
San Francisco District
1455 Market Street
San Francisco, CA 94103

MATCHLINE - SHEET 3

MATCHLINE - SHEET 1