

VICINITY MAP  
NOT TO SCALE

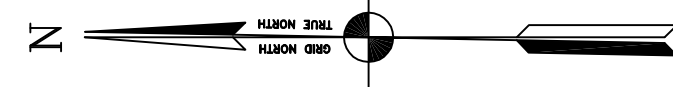

PRELIMINARY ISSUE  
THIS PLAN ISSUED FOR  
ADVANCE INFORMATION ONLY

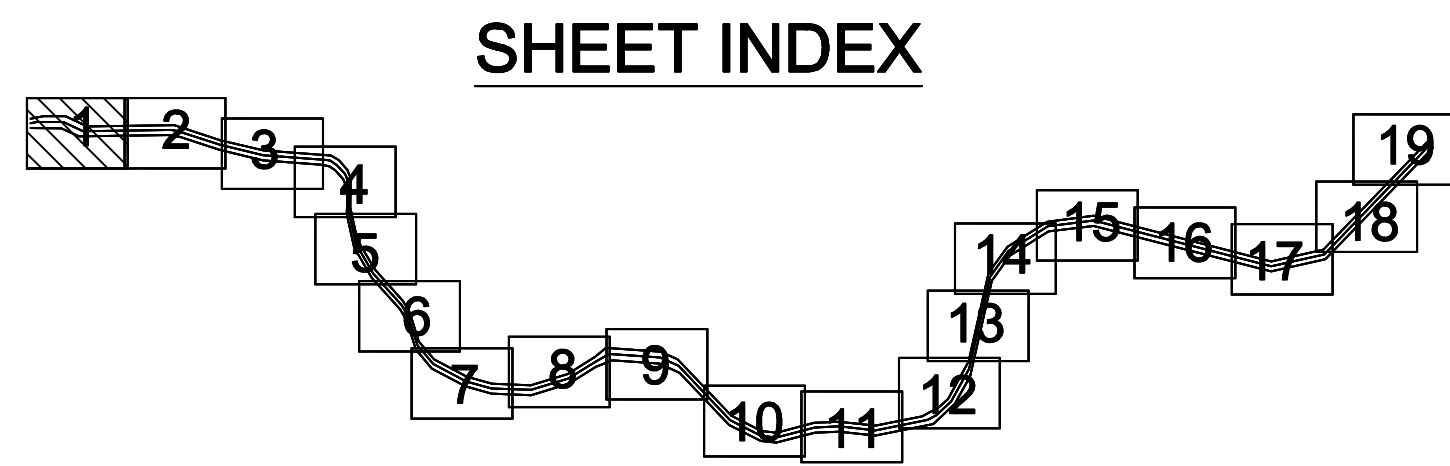
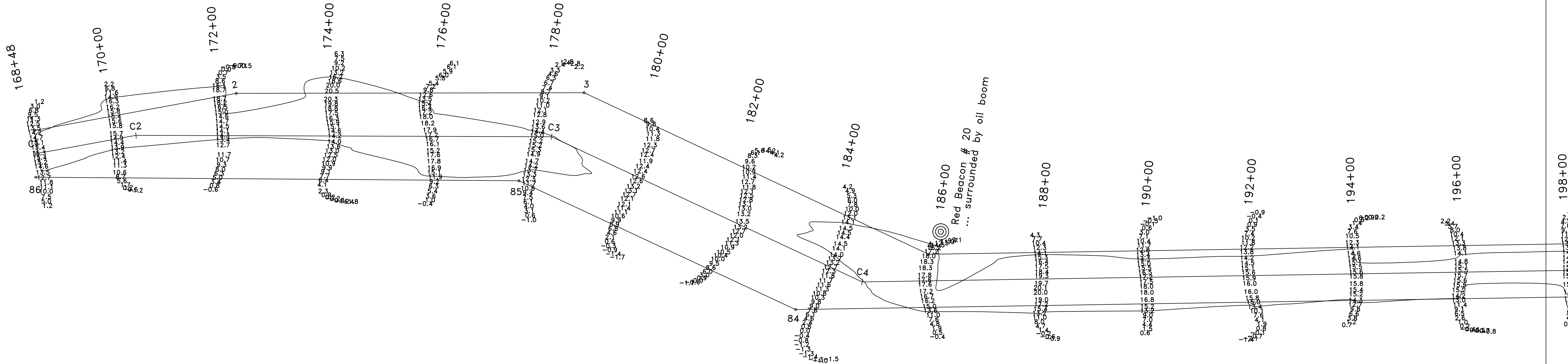

SHEET INDEX

NAD 83 CHANNEL ANGLE POINTS					
Δ PT	X	Y	Δ PT	X	Y
1	6049459.67	2285526.34	44	6048776.47	2243801.94
2	6049529.47	2285146.44	45	6045465.77	2246990.64
3	6049530.77	2284491.14	46	6045104.57	2248601.44
4	6049226.77	2283841.84	47	6046463.57	2253889.24
5	6049268.97	2281248.54	48	6046295.27	2255227.24
6	6048820.67	2279884.34	49	6045574.57	2256380.54
7	6048508.67	2278592.34	50	6044829.57	2256914.24
8	6048361.67	2276596.34	51	6041981.27	2257556.34
9	6048224.67	2276357.34	52	6041162.17	2258023.54
10	6047934.67	2276096.34	53	6040567.87	2258659.04
11	6047695.67	2275999.34	54	6040216.47	2260379.94
12	6046816.67	2276013.34	55	6040339.47	2261458.94
13	6045857.67	2275806.34	56	6040309.17	2262182.24
14	6044974.67	2275292.34	57	6040008.17	2263335.04
15	6044027.67	2274440.34	58	6040056.67	2263787.24
16	6043687.67	2274244.34	59	6040535.87	2264731.14
17	6042827.67	2273971.34	60	6042092.17	2266208.54
18	6042289.67	2273516.34	61	6042363.87	2266814.94
19	6041777.67	2272546.34	62	6042461.77	2268207.44
20	6041569.67	2271791.34	63	6042271.07	2268696.74
21	6041525.67	2270640.34	64	6041765.47	2269501.94
22	6041855.57	2269548.54	65	6041425.07	2270626.74
23	6042372.87	2268724.04	66	6041470.17	2271806.74
24	6042635.67	2268399.34	67	6041684.17	2272583.44
25	6042521.47	2268775.44	68	6042209.87	2273580.14
26	6042293.47	2268266.44	69	6042778.37	2274060.64
27	6040617.67	2264671.34	70	6043647.07	2274336.34
28	6040160.57	2263771.04	71	6043968.57	2274521.74
29	6040114.97	2263317.64	72	6044915.45	2275373.54
30	6040408.67	2262196.34	73	6045821.07	2275900.74
31	6040439.67	2261455.34	74	6046906.77	2276113.54
32	6040317.67	2260384.34	75	6047548.97	2276101.64
33	6040601.67	2258993.34	76	6047853.87	2276225.44
34	6040860.67	2258492.34	77	6048114.07	2276459.54
35	6041115.47	2258219.34	78	6048226.67	2276626.34
36	6042227.87	2257612.54	79	6048279.57	2276834.64
37	6044972.97	2257005.84	80	6048409.57	2277807.84
38	6045649.57	2256449.54	81	6048724.37	2279111.74
39	6046392.27	2255264.24	82	6049106.27	2281073.74
40	6046565.17	2253882.84	83	6049165.45	2281463.74
41	6045207.47	2248599.84	84	6049122.77	2284092.54
42	6045556.47	2247042.94	85	6049364.97	2284613.94
43	6048864.47	2243853.94	86	6049371.67	2285524.34

NAD 83 CENTERLINE ANGLE POINTS				
Δ PT	X	Y	Δ PT	
1	6049415.67	2285525.34	1	6049450.57
2	6049450.57	2285335.44	2	6049447.87
3	6049447.87	2284552.54	3	6049174.77
4	6049174.77	2283967.14	4	6049217.17
5	6049217.17	2281356.14	5	6049187.67
6	6049187.67	2281161.14	6	6048772.57
7	6048772.57	2279888.04	7	6048459.07
8	6048459.07	2278600.14	8	6048320.67
9	6048320.67	2276710.44	9	6048294.17
10	6048294.17	2276606.34	10	6048169.37
11	6048169.37	2276408.44	11	6047894.27
12	6047894.27	2276160.84	12	6047622.37
13	6047622.37	2276050.54	13	6046811.77
14	6046811.77	2276063.44	14	6045839.37
15	6045839.37	2275853.54	15	6044945.07
16	6044945.07	2275332.94	16	6043998.17
17	6043998.17	2274481.04	17	6043667.37
18	6043667.37	2274290.34	18	6042802.97
19	6042802.97	2274015.64	19	6042249.97
20	6042249.97	2273548.24	20	6041730.87
21	6041730.87	2272564.84	21	6041519.87
22	6041519.87	2271799.04	22	6041475.37
23	6041475.37	2271806.74	23	6041810.47
24	6041810.47	2269525.24	24	6042321.97
25	6042321.97	2268710.44	25	6042548.77
26	6042548.77	2268303.34	26	6042442.67
27	6042442.67	2266795.24	27	6042192.87
28	6042192.87	2266237.54	28	6040576.77
29	6040576.77	2264701.24	29	6040108.67
30	6040108.67	2263779.14	30	6040061.57
31	6040061.57	2263336.34	31	6040358.97
32	6040358.97	2262189.24	32	6040389.57
33	6040389.57	2261457.14	33	6040267.07
34	6040267.07	2260382.14	34	6040584.77
35	6040584.77	2258826.14	35	6040714.27
36	6040714.27	2258575.64	36	6041138.77
37	6041138.77	2258121.74	37	6041203.77
38	6041203.77	2257586.34	38	6044851.27
39	6044851.27	2256960.04	39	6045612.07
40	6045612.07	2256415.04	40	6046343.47
41	6046343.47	2255244.34	41	6046514.37
42	6046514.37	2253696.04	42	6045155.97
43	6045155.97	2248600.64	43	6045511.07
44	6045511.07	2247016.84	44	6048819.87
45	6048819.87	2243829.54	45	

NOTES:

DRAWING NOT TO BE USED AS NAVIGATION. ONLY CHANNEL CONDITION AT DATE OF SURVEY. THE LOCATION OF ALL NAVIGATION AIDS ARE BASED ON INFORMATION PROVIDED BY THE U.S. COAST GUARD. BUOY LOCATIONS REPRESENT THE POSITION OF THE SINKER ONLY.

SURVEYED BY THE CORPS OF ENGINEERS.

SOUNDINGS FOR THE OUTSIDE CHANNEL (100 FT. WIDE) TAKEN BY FATHOMETER; THE INSIDE CHANNEL (60 FT. WIDE) TAKEN BY LEADLINE, AND ARE SHOWN TO THE NEAREST FOOT AND TENTHS OF A FOOT.

SOUNDINGS ARE BASED ON THE DATUM OF MEAN LOWER LOW WATER AT THE LOCALITY. NGVD 1929.

PLANE GRID AND COORDINATES ARE BASED ON THE STATE OF CALIFORNIA COORDINATE SYSTEM, LAMBERT CONFORMAL PROJECTION, ZONE III NAD 83, CALIFORNIA, AS DESCRIBED IN SPECIAL PUBLICATION NO. 235, PUBLISHED BY THE NATIONAL OCEAN SURVEY.

VERTICAL CONTROL:  
168+48 - 190+00 MON. 20 USC&GS DISC 23.60 M.L.L.W.  
190+00 - 536+00 MON. TIDAL 1 1922 USCGS DISC 7.86 M.L.L.W.  
536+00 - 692+23 CAP DOCK 1995 2" DISC RG 15310 11.81 M.L.L.W.

PROJECT DEPTH IS 15 FEET FROM ENTRANCE AT THE MARE ISLAND CAUSEWAY TO AYLUAM SLOUGH, THENCE 10 FEET TO HEAD OF NAVIGATION.

GRAPHICS SCALE 1" = 100'

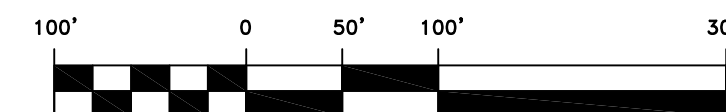

2,285,000 6,050,000 6,049,000 2,285,000

US Army Corps of Engineers  
San Francisco District  
353 Market Street  
San Francisco, CA 94105

Mark	Description	Date	Appr.

SUBMITTED:	PC	DESIGNED BY:	TYW	DRAWN BY:	EWC
Hydro Survey Section	APPROVAL RECOMMENDED:	DATE:	5/5/2003	SHEET NO.:	1 OF 19
Chief, Engineering Branch	APPROVED:	PREPARED UNDER THE DIRECTION OF:	MICHAEL MCCORMICK	DRAWING NO.:	2 160
Chief, Engineering Technical & Services Div.			LT. COLONEL, C.E., DISTRICT ENGINEER		

CALIFORNIA  
NAPA COUNTY  
NAPA RIVER  
CONDITION SURVEY  
23-25 APRIL 2003

Sheet reference number  
C1

MATCHLINE - SHEET 2