

PRELIMINARY ISSUE  
THIS PLAN ISSUED FOR  
ADVANCE INFORMATION ONLY

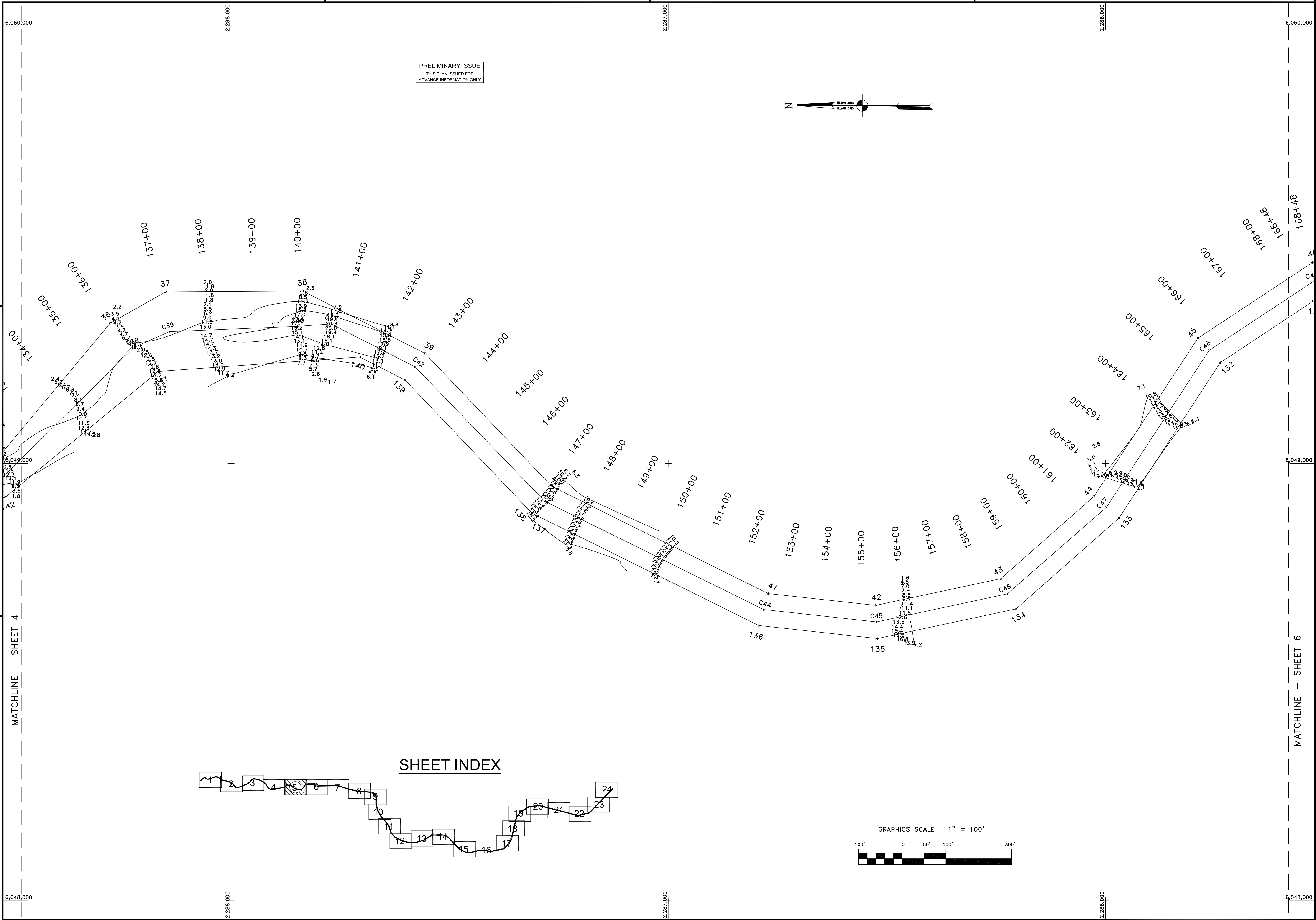
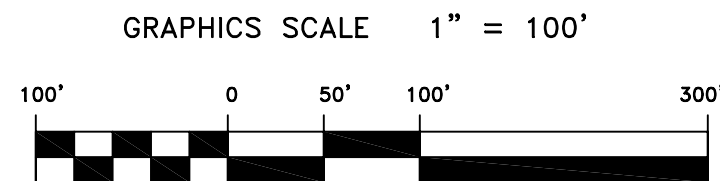
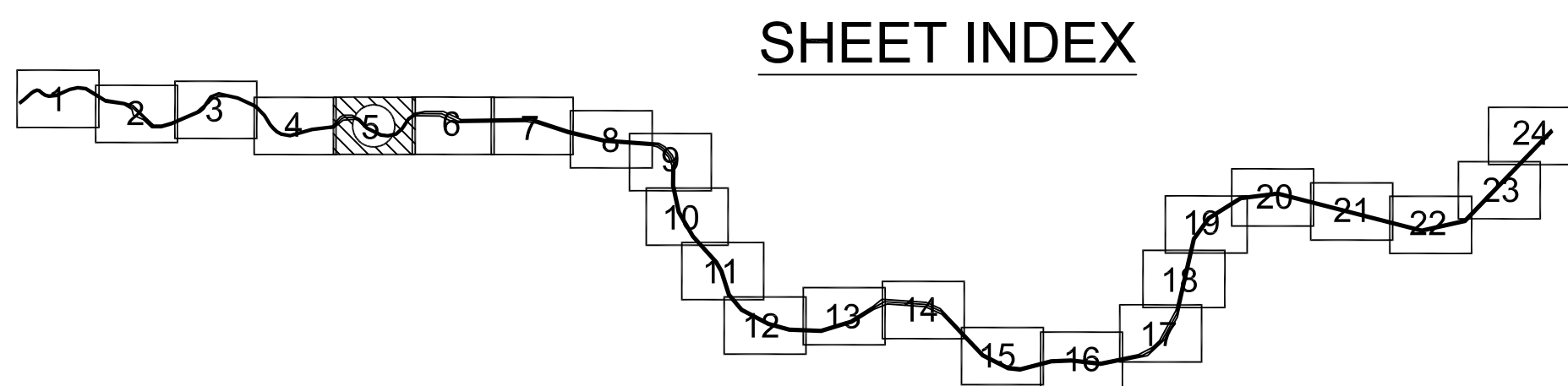
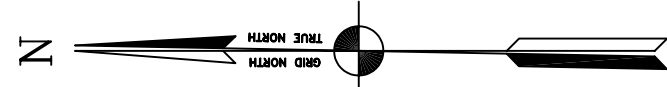

US Army Corps  
of Engineers  
San Francisco District  
333 Market Street  
San Francisco, CA 94105

Mark	Description	Date	Appr.

SUBMITTED:	DESIGNED BY:	CHECKED BY:	DRAWN BY:
Hess Survey Section	PDT	PDT	HSS
APPROVAL RECOMMENDED:	DATE:	SHEET NO.:	DRAWING NO.:
Chief, Engineering Branch	9/3/2004	5 OF 24	2 OF 161
APPROVED:	PREPARED UNDER THE DIRECTION OF:	PHILIP T. FEIR	
Chief, Engineering & Technical Services Div.	LT. COLONEL, C.E., DISTRICT ENGINEER		

CALIFORNIA  
NAPA COUNTY  
NAPA RIVER  
CONDITION SURVEY  
9-25 JUNE 2004

Sheet reference number  
C5