

PRELIMINARY ISSUE  
THIS PLAN ISSUED FOR  
ADVANCE INFORMATION ONLY

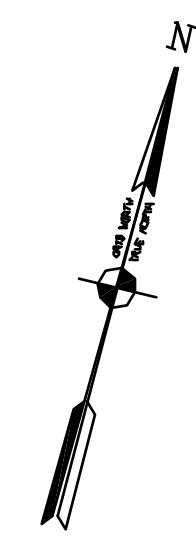

US Army Corps  
of Engineers  
San Francisco District  
455 Market Street  
San Francisco, CA 94103

MARK	DESCRIPTION	DATE	APP.

DESIGNED BY:	CHECKED BY:	DATE:	SHEET NO.	DRAWING NO.
PDT	PDT	7/25/2013	6 OF 8	2 XXX

PREPARED UNDER THE DIRECTION OF  
JOHN K. BAKER  
LT. COLONEL, C.E., DISTRICT ENGINEER

ALAMEDA COUNTY  
OAKLAND HARBOR  
INNER HARBOR  
PRE-SOLICITATION SURVEY  
18 & 25 JULY 2013

Sheet  
reference  
number  
**C6**

TABLE 2  
N.A.D. 1983 COORDINATES  
INNER HARBOR CHANNEL ANGLE POINTS AND CONTROL LINE

CHANNEL ∠ PT.	EASTING	N ORTHING	CL ∠ PT.	EASTING	N ORTHING
-1	E 6023762.09	N 2118950.51	C1-1	E 6023646.15	N 2119462.15
-2	E 6024157.22	N 2119040.07	C2-1	E 6024036.26	N 2119550.55
-3	E 6025473.56	N 2119570.70	C3-1	E 6025595.15	N 2119980.13
-4	E 6027845.43	N 2116493.40	C4-1	E 6026240.30	N 2120146.50
-5	E 6029016.57	N 2116810.96	C5-1	E 6027834.44	N 2120362.55
-6	E 6032404.38	N 2116090.73	C6-1	E 6028520.38	N 2120324.00
-7	E 6032730.19	N 2116091.23	C7-1	E 6029460.16	N 2119600.14
-8	E 6033362.09	N 2117836.07	C8-1	E 6029982.52	N 2119311.30
-9	E 6035409.49	N 2117249.85	C9-1	E 6032849.53	N 2118429.13
-10	E 6037795.20	N 2116472.91	C10-1	E 6033991.54	N 2118062.12
-11	E 6039039.12	N 2116096.20	C11-1	E 6039959.88	N 2116091.53
-12	E 6040654.58	N 2115539.56	C12-1	E 6040877.50	N 2115915.79
-13	E 6042043.68	N 2115391.38	C13-1	E 6041540.72	N 2115860.01
-14	E 6044049.16	N 2115748.91	C14-1	E 6042068.48	N 2115814.83
-15	E 6044280.53	N 2115448.21	C15-1	E 6042523.82	N 2115844.55
-16	E 6044574.83	N 2115301.16	C16-1	E 6042762.57	N 2115860.14
-17	E 6044943.04	N 2115301.09	C17-1	E 6043906.03	N 2116056.12
-18	E 6045282.44	N 2115469.88	C18-1	E 6045627.74	N 2116304.23
-19	E 6045598.27	N 2115919.54	C19-1	E 6047090.98	N 2116244.72
-20	E 6047077.42	N 2115911.23			
-21	E 6047104.54	N 2115577.48			
-22	E 6045070.66	N 2116733.32			
-23	E 6044970.66	N 2116868.32			
-24	E 6044443.67	N 2116787.33			
-25	E 6044237.67	N 2116595.33			
-26	E 6043848.67	N 2116407.34			
-27	E 6042706.68	N 2116202.36			
-28	E 6040041.68	N 2116358.42			
-29	E 6030243.21	N 2119742.79			
-30	E 6029638.99	N 2120190.77			
-31	E 6029195.32	N 2121154.59			
-32	E 6027016.64	N 2121132.23			
-33	E 6025557.78	N 2120540.53			
-34	E 6023915.29	N 2120061.03			
-35	E 6023530.21	N 2119973.81			

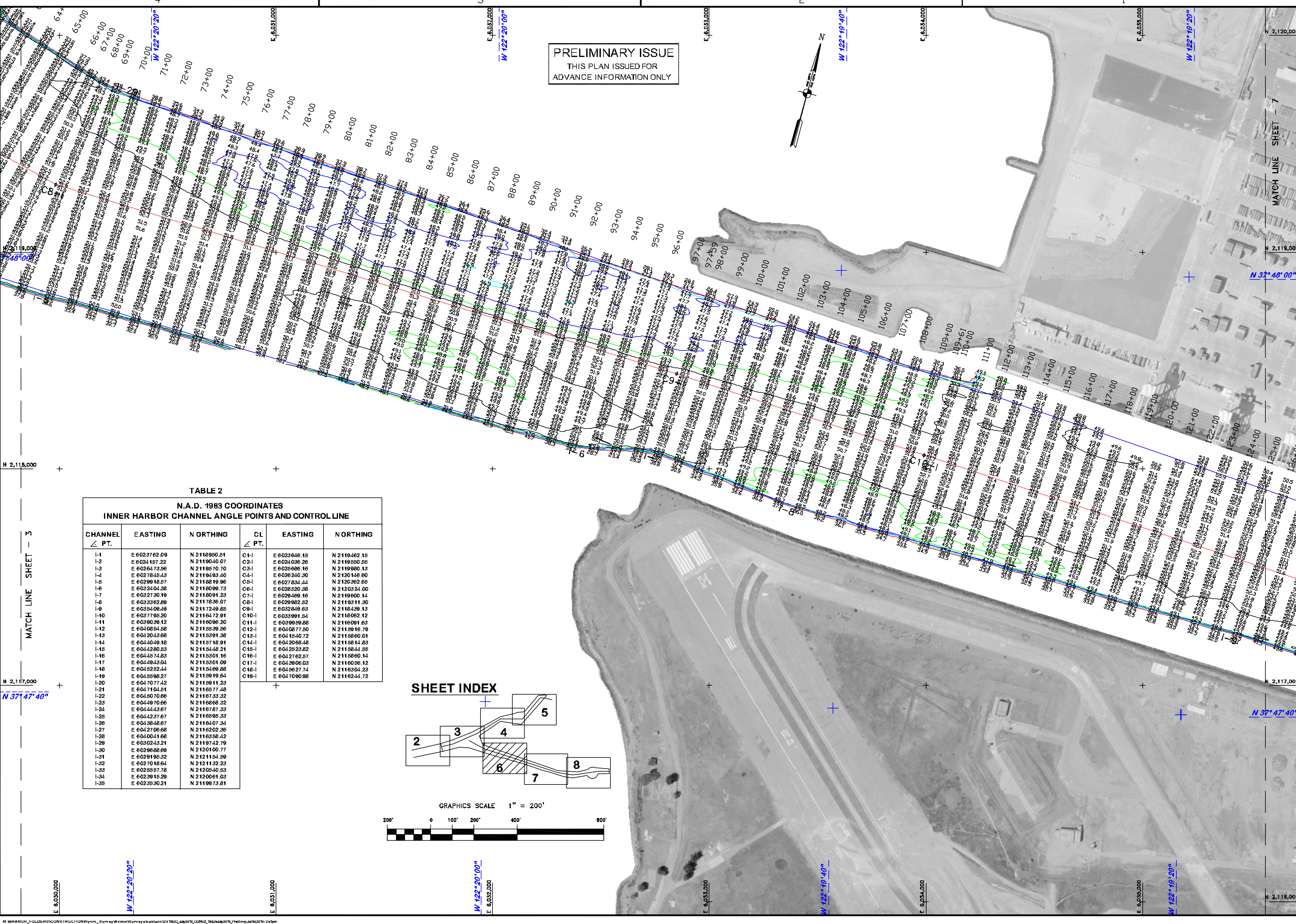
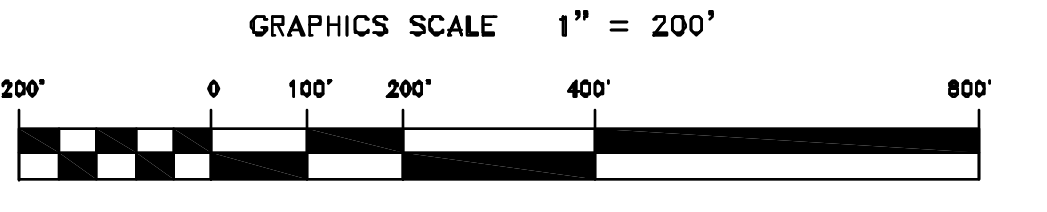
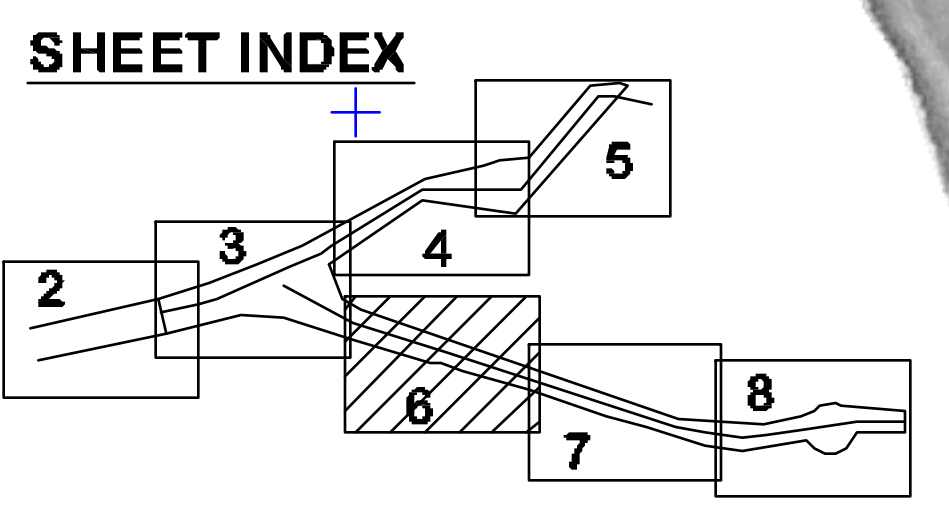

E 6,030,000  
W 122° 20' 20"  
E 6,031,000  
W 122° 20' 00"  
E 6,032,000  
W 122° 19' 40"  
E 6,033,000  
W 122° 19' 20"  
E 6,034,000  
W 122° 19' 00"  
E 6,035,000  
W 122° 18' 40"  
E 6,036,000  
W 122° 18' 20"  
E 6,037,000  
W 122° 18' 00"