

PRELIMINARY ISSUE  
 THIS PLAN ISSUED FOR  
 ADVANCE INFORMATION ONLY

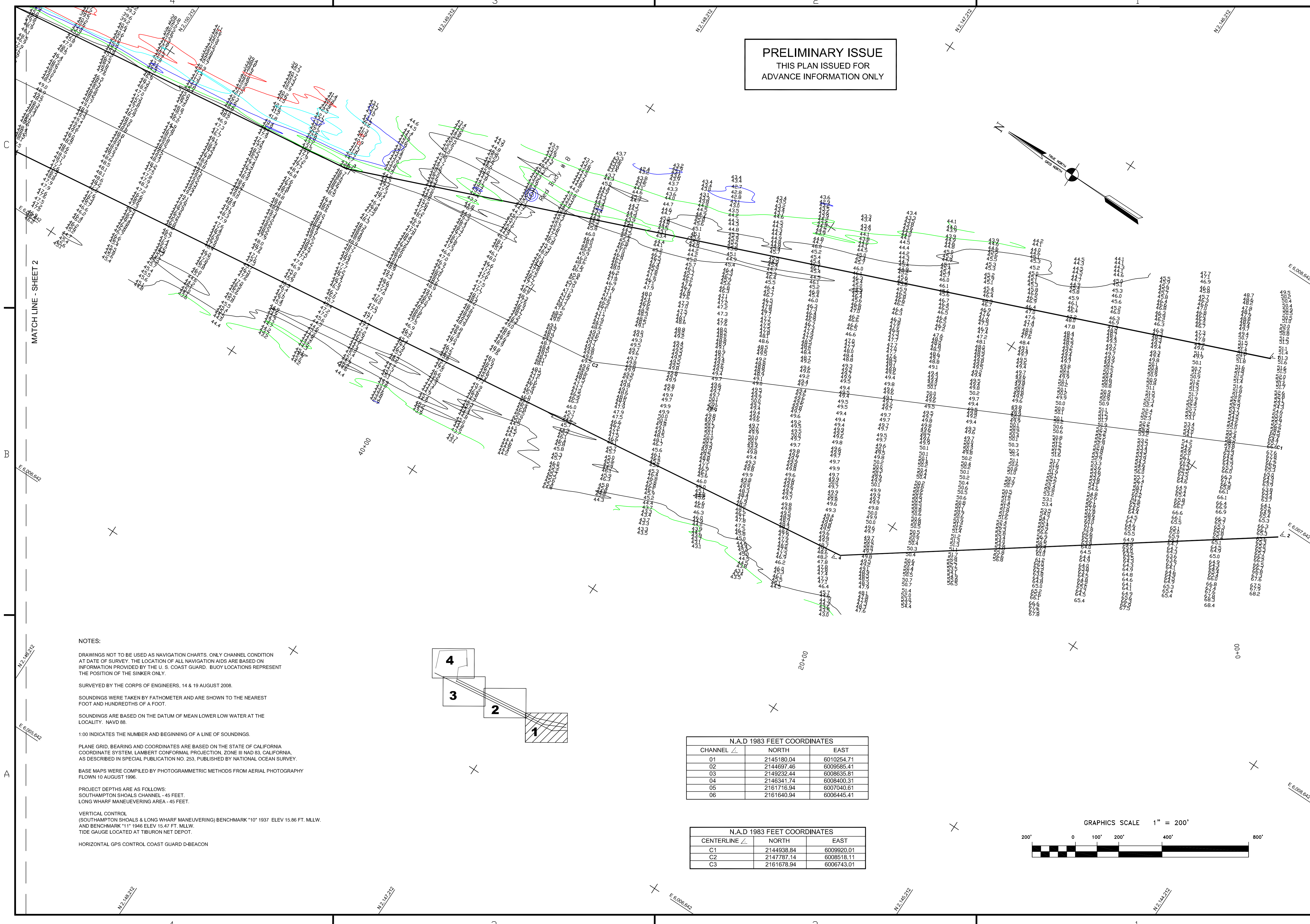

**NOTES:**

DRAWINGS NOT TO BE USED AS NAVIGATION CHARTS. ONLY CHANNEL CONDITION AT DATE OF SURVEY. THE LOCATION OF ALL NAVIGATION AIDS ARE BASED ON INFORMATION PROVIDED BY THE U. S. COAST GUARD. BUOY LOCATIONS REPRESENT THE POSITION OF THE SINKER ONLY.

SURVEYED BY THE CORPS OF ENGINEERS, 14 & 19 AUGUST 2008.

SOUNDINGS WERE TAKEN BY FATHOMETER AND ARE SHOWN TO THE NEAREST FOOT AND HUNDRETHS OF A FOOT.

SOUNDINGS ARE BASED ON THE DATUM OF MEAN LOWER LOW WATER AT THE LOCALITY. NAVD 88.

1:00 INDICATES THE NUMBER AND BEGINNING OF A LINE OF SOUNDINGS.

PLANE GRID, BEARING AND COORDINATES ARE BASED ON THE STATE OF CALIFORNIA COORDINATE SYSTEM, LAMBERT CONFORMAL PROJECTION, ZONE III NAD 83, CALIFORNIA, AS DESCRIBED IN SPECIAL PUBLICATION NO. 253, PUBLISHED BY NATIONAL OCEAN SURVEY.

BASE MAPS WERE COMPILED BY PHOTOGRAMMETRIC METHODS FROM AERIAL PHOTOGRAPHY FLOWN 10 AUGUST 1996.

PROJECT DEPTHS ARE AS FOLLOWS:  
 SOUTHAMPTON SHOALS CHANNEL - 45 FEET.  
 LONG WHARF MANEUVERING AREA - 45 FEET.

VERTICAL CONTROL  
 (SOUTHAMPTON SHOALS & LONG WHARF MANEUVERING) BENCHMARK "10" 1937 ELEV 15.86 FT. MLLW.  
 AND BENCHMARK "11" 1946 ELEV 15.47 FT. MLLW.  
 TIDE GAUGE LOCATED AT TIBURON NET DEPOT.

HORIZONTAL GPS CONTROL COAST GUARD D-BEACON

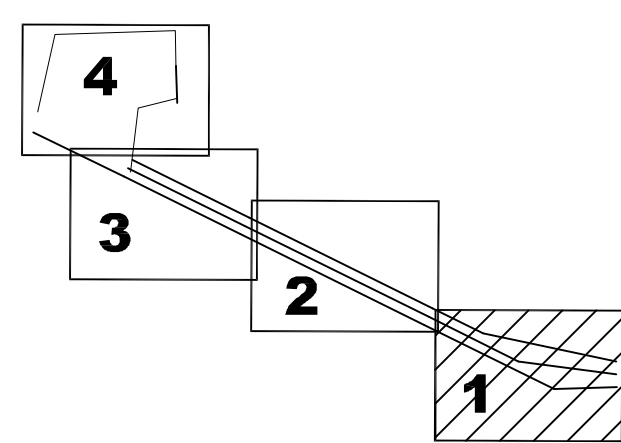

N.A.D 1983 FEET COORDINATES

CHANNEL	NORTH	EAST
01	2145180.04	6010254.71
02	2144697.46	6009585.41
03	2149232.44	6008635.81
04	2146341.74	6008400.31
05	2161716.94	6007040.61
06	2161640.94	6006445.41

N.A.D 1983 FEET COORDINATES

CENTERLINE	NORTH	EAST
C1	2144938.84	6009920.01
C2	2147787.14	6008518.11
C3	2161678.94	6006743.01

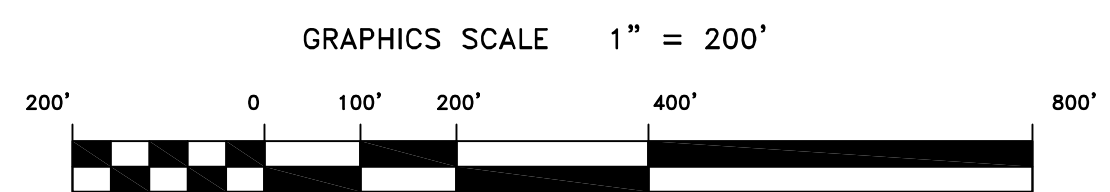

Mark	Description	Date	Appr.

SUBMITTED:	MC	DESIGNED BY:	TVW	CHECKED BY:	EMC
	Hydro Survey Team Leader	DATE:	SHEET NO.	DRAWING NO.	DRAWING NO.
APPROVAL RECOMMENDED:		8/25/2008	1 OF 4	9	2
APPROVED:		PREPARED UNDER THE DIRECTION OF LAURENCE M. FARRELL LT. COLONEL, C.E., DISTRICT ENGINEER			
Chief, Construction Branch					

CALIFORNIA  
 CONTRA COSTA COUNTY  
 RICHMOND OUTER HARBOR  
 SOUTH HAMPTON SHOALS  
 CHANNEL SURVEY  
 14 & 19 AUGUST 2008

Sheet reference number  
**C1**