

PRELIMINARY ISSUE
THIS PLAN ISSUED FOR
ADVANCE INFORMATION ONLY

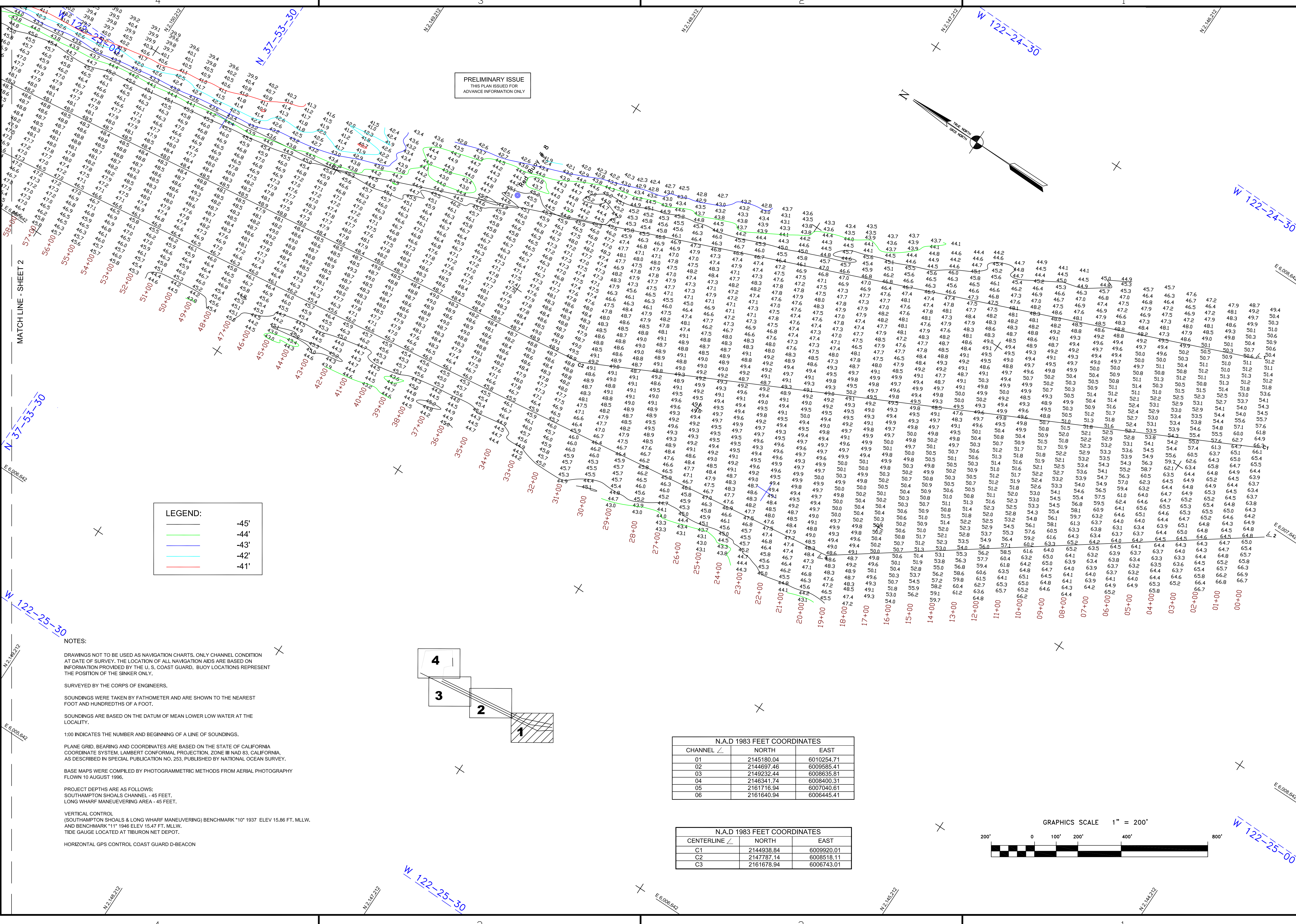

LEGEND:

—	-45'
—	-44'
—	-43'
—	-42'
—	-41'

NOTES:
DRAWINGS NOT TO BE USED AS NAVIGATION CHARTS. ONLY CHANNEL CONDITION AT DATE OF SURVEY. THE LOCATION OF ALL NAVIGATION AIDS ARE BASED ON INFORMATION PROVIDED BY THE U. S. COAST GUARD. BUOY LOCATIONS REPRESENT THE POSITION OF THE SINKER ONLY.

SURVEYED BY THE CORPS OF ENGINEERS.
SOUNDINGS WERE TAKEN BY FATHOMETER AND ARE SHOWN TO THE NEAREST FOOT AND HUNDRETHS OF A FOOT.

SOUNDINGS ARE BASED ON THE DATUM OF MEAN LOWER LOW WATER AT THE LOCALITY.

1:00 INDICATES THE NUMBER AND BEGINNING OF A LINE OF SOUNDINGS.

PLANE GRID, BEARING AND COORDINATES ARE BASED ON THE STATE OF CALIFORNIA COORDINATE SYSTEM, LAMBERT CONFORMAL PROJECTION, ZONE III NAD 83, CALIFORNIA, AS DESCRIBED IN SPECIAL PUBLICATION NO. 253, PUBLISHED BY NATIONAL OCEAN SURVEY.

BASE MAPS WERE COMPILED BY PHOTOGRAMMETRIC METHODS FROM AERIAL PHOTOGRAPHY FLOWN 10 AUGUST 1996.

PROJECT DEPTHS ARE AS FOLLOWS:
SOUTHAMPTON SHOALS CHANNEL - 45 FEET.
LONG WHARF MANEUVERING AREA - 45 FEET.

VERTICAL CONTROL
(SOUTHAMPTON SHOALS & LONG WHARF MANEUVERING) BENCHMARK *10" 1937 ELEV 15.86 FT. MLLW.
AND BENCHMARK *11" 1946 ELEV 15.47 FT. MLLW.
TIDE GAUGE LOCATED AT TIBURON NET DEPOT.

HORIZONTAL GPS CONTROL COAST GUARD D-BEACON

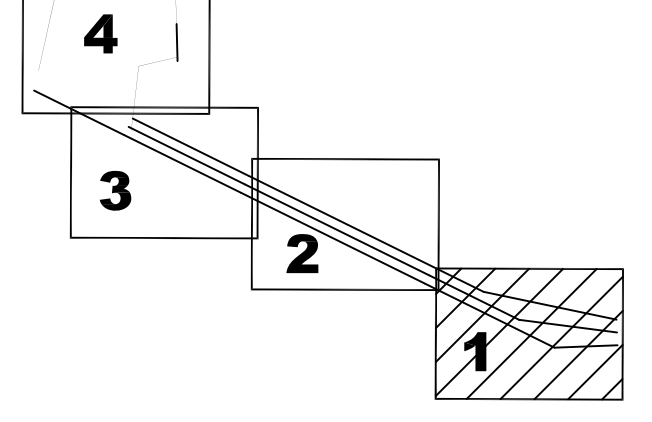

N.A.D 1983 FEET COORDINATES

CHANNEL	NORTH	EAST
01	2145180.04	6010254.71
02	2144697.46	6009585.41
03	2149232.44	6008635.81
04	2146341.74	6008400.31
05	2161716.94	6007040.61
06	2161640.94	6006445.41

N.A.D 1983 FEET COORDINATES

CENTERLINE	NORTH	EAST
C1	2144938.84	6009920.01
C2	2147787.14	6008518.11
C3	2161678.94	6006743.01

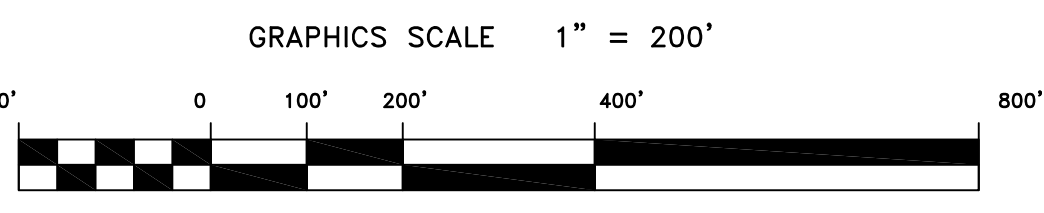

Mark	Date	Appr.

Mark	Date	Appr.

SUBMITTED:	PDT	INTELSUR Team Leader
DESIGNED BY:	CHECKED BY:	DRAWN BY:
DATE:	SHEET NO.	PDT
2/20/2013	1 OF 4	9 2
APPROVAL RECOMMENDED:		
CHIEF, Hydro Survey Section		
PREPARED UNDER THE DIRECTION OF:		
JOHN K. BAKER		
APPROVED:		
LT. COLONEL, C.E., DISTRICT ENGINEER		

CALIFORNIA
CONTRA COSTA COUNTY
RICHMOND HARBOR
SOUTHAMPTON SHOALS
CONDITION SURVEY
20 FEBRUARY 2013

Sheet reference number
C1