

Mark	Description	Date	Appr.

DRAWN BY: EC		CHECKED BY: TYW		DESIGNED BY:	
123	2	91	5	2002/01/01	
SUBMITTED:					
APPROVAL RECOMMENDED:					
APPROVED:					
Survey Station Item Leader				Lt. Colonel Craig W. Kiley	
Chief, Technical Support Section				District Engineer	
Chief, Construction Branch				Lt. Colonel Craig W. Kiley	

CALIFORNIA
CONTRA COSTA COUNTY
SUISUN BAY CHANNEL
PREDRIDGE SURVEY
12, '11, '12, '14, '18, '20 & 22 SEPTEMBER 2007

Sheet reference number
C3

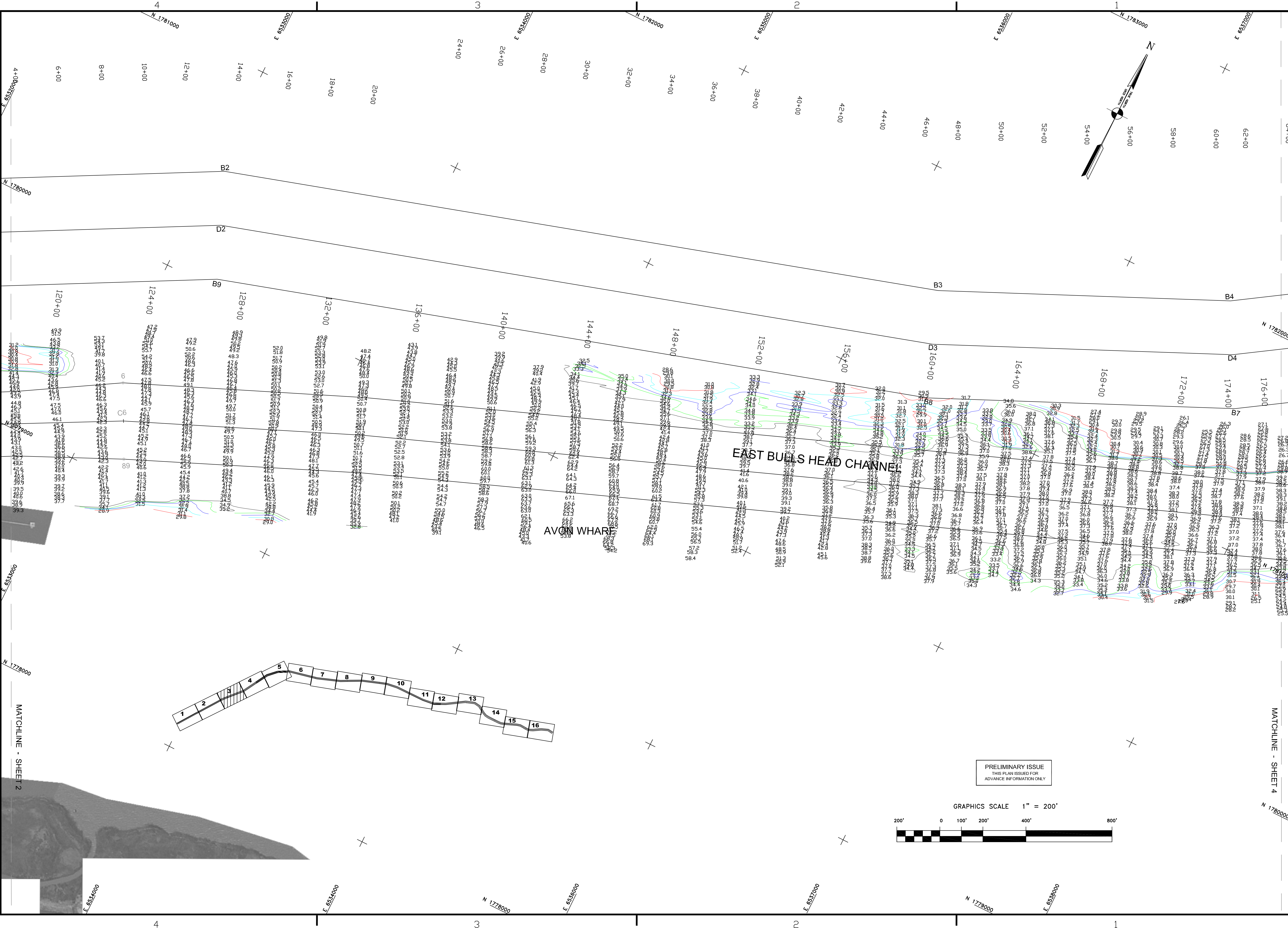

MATCHLINE - SHEET 2

MATCHLINE - SHEET 4