

PRELIMINARY ISSUE
THIS PLAN ISSUED FOR
ADVANCE INFORMATION ONLY

US Army Corps
of Engineers
San Francisco District
1455 Market Street
San Francisco, CA 94103

Description	Date	Appr.

Mark	Description	Date	Appr.

SUBMITTED BY:	PDT	DATE	DESIGNED BY:	PDT	DATE	CHECKED BY:	PDT	DATE	DRAWN BY:	PDT	DATE	APPROVAL RECOMMENDED:		
												Survey Section Team Leader	Chief, Elements Section	Chief, Construction Branch

PREPARED UNDER THE DIRECTION OF
TORREY A. DICIRO
LT. COLONEL, C.E., DISTRICT ENGINEER

CALIFORNIA
CONTRA COSTA COUNTY
**SUISUN BAY CHANNEL
CONDITION SURVEY**
6-7, 14-15, 18&20 APRIL 2011

Sheet
reference
number
G10

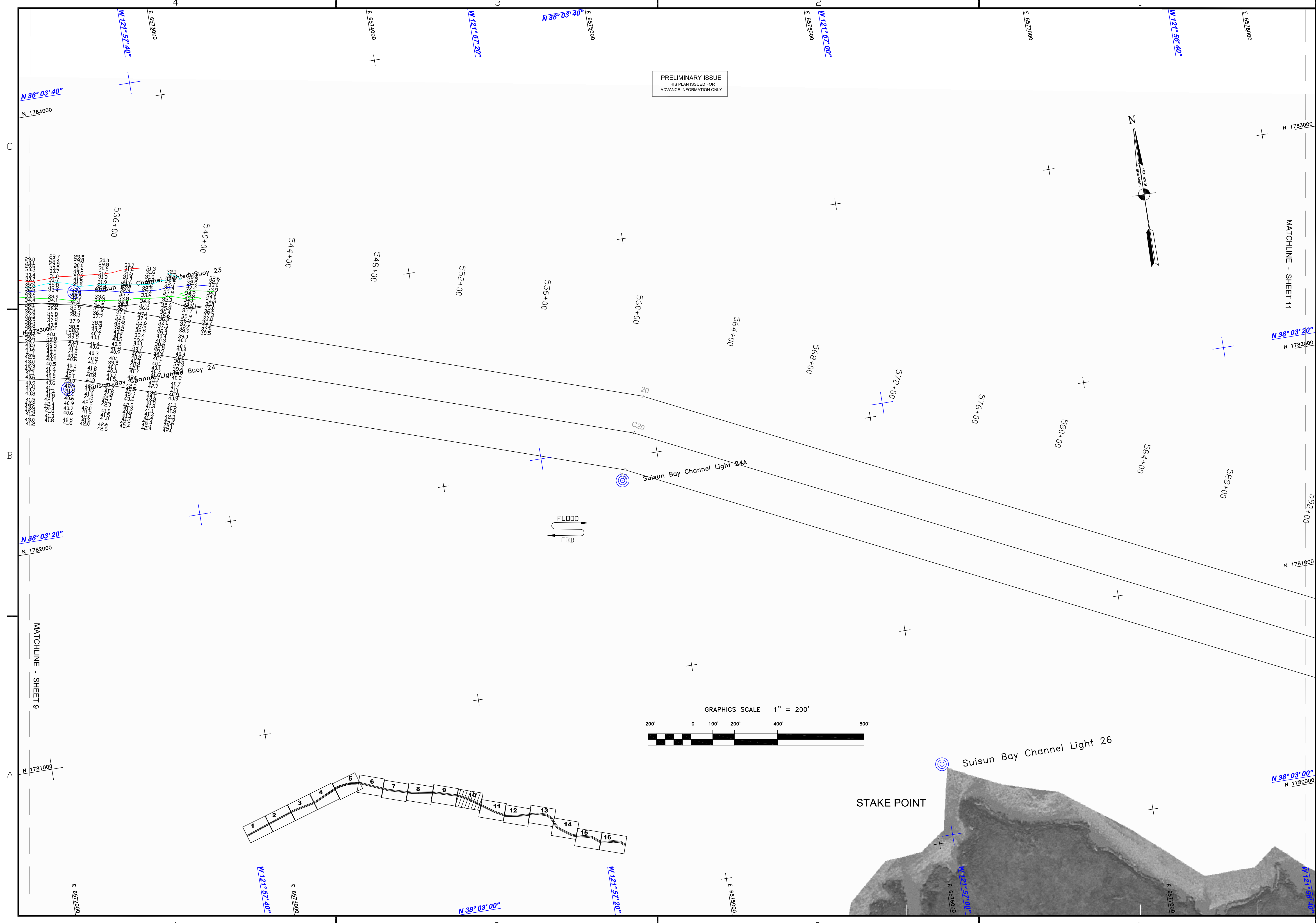

MATCHLINE - SHEET 9

MATCHLINE - SHEET 11

N 1784000

N 1783000

N 1782000

N 1781000

N 1781000

N 1780000

E 6572000

E 6573000

E 6574000

E 6575000

E 6576000

E 6577000

E 6578000

E 6579000